

PATENT PENDING

| PART NO. | "A" DIM   | MATERIAL | TRAVEL    |
|----------|-----------|----------|-----------|
| TCS-1    | 5.4[0.22] | RMS-01   | 3.0[0.12] |
| TCS-2    |           | RMS-19   |           |
| TCS-3    | 4.2[0.16] | RMS-01   |           |
| TCS-4    |           | RMS-19   |           |

| REV | MODIFICATION       | DATE     | DRN |
|-----|--------------------|----------|-----|
| 1   | PRODUCTION RELEASE | 27/10/04 | I.C |
| 2   | SCN 2004-206       | 02/12/04 | I.C |
| 3   | SCN 2005-066       | 24/05/05 | I.C |
| 4   | CO2010418          | 01/10/08 | I.C |
| 5   | CO2010390          | 21/10/08 | I.C |
| 6   | CO2010566          | 17/02/09 | S.F |

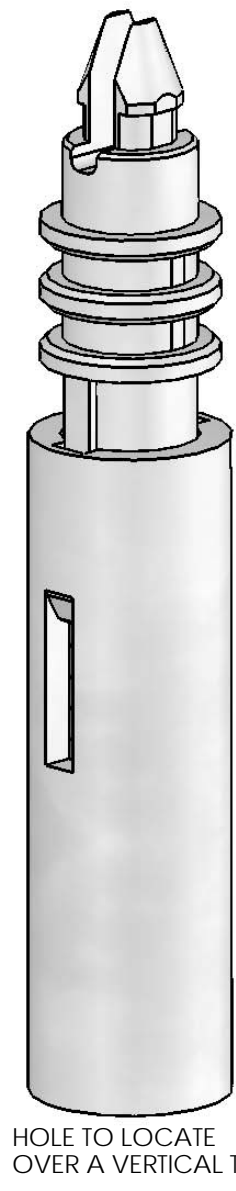
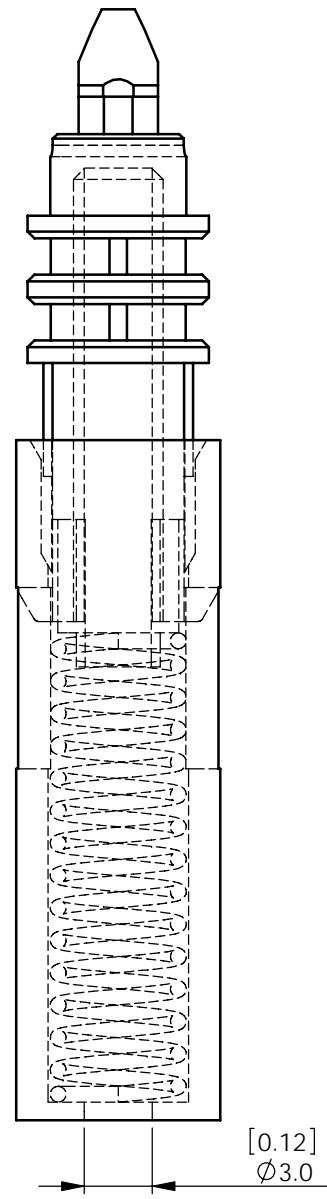
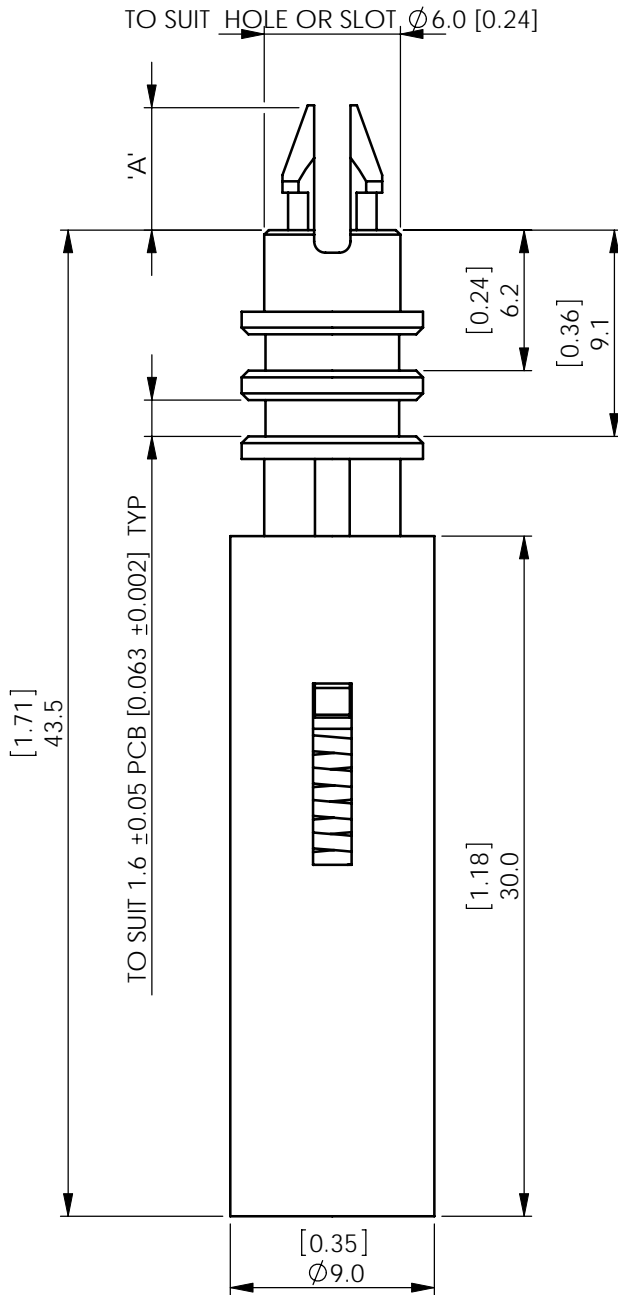

FIX TO SNAP-LOCK INTO :  
 $\phi 4.2 \pm 0.05$  [0.165"  $\pm 0.002$ ] HOLE  
 $1.6 \pm 0.05$  [0.063"  $\pm 0.002$ ] PANEL THICKNESS

MATERIAL: NYLON 6/6 UL94 V-2 (RMS-01)  
 OR NYLON 6/6 UL94 V-0 (RMS-19)  
 SPRING: STAINLESS STEEL (RMS-230)

OTHER SPRING FORCES, MOUNTS  
 & SPACER LENGTHS AVAILABLE  
 BY SPECIAL ORDER.

ALTERNATE UNITS FOR REFERENCE ONLY

INFORMATION CONTAINED IN THIS DOCUMENT IS CONFIDENTIAL TO RICHCO INTERNATIONAL Co. Ltd. AND MAY NOT BE DISCLOSED OR REPRODUCED IN WHOLE OR PART WITHOUT THEIR WRITTEN CONSENT

|  |  |
|--|--|
|  | METRIC GENERAL TOLERANCES $\pm 0.25$<br>ARE PRIMARY UNLESS OTHERWISE STATED<br>1 DECIMAL PLACE $\pm 0.25$<br>2 DECIMAL PLACES $\pm 0.10$<br>ANGULAR $\pm 1^\circ$    |
|  | IMPERIAL GENERAL TOLERANCES $\pm 0.010$<br>ARE FOR REFERENCE UNLESS OTHERWISE<br>1 DECIMAL PLACE $\pm 0.01$<br>2 DECIMAL PLACES $\pm 0.005$<br>ANGULAR $\pm 1^\circ$ |

|                                |                      |                     |                  |
|--------------------------------|----------------------|---------------------|------------------|
| MATERIAL:<br>SEE ABOVE         |                      | COLOUR:<br>NATURAL  |                  |
| TITLE:<br>TOUCH CONTROL SPACER |                      | PART No:<br>TCS - X |                  |
| DRG No:<br>04-111              | NPR REF:<br>2004-108 |                     | SIZE<br>A4       |
| DRN<br>I.C                     | DATE<br>22/10/04     | CHKD<br>SF          | DATE<br>17/02/09 |
| SCALE<br>3:1                   |                      | SHEET No<br>1 OF 1  |                  |