

PCB terminal block - SPT 5/ 7-H-7,5-ZB - 1719244

Please be informed that the data shown in this PDF Document is generated from our Online Catalog. Please find the complete data in the user's documentation. Our General Terms of Use for Downloads are valid (<http://download.phoenixcontact.com>)

PCB terminal block, Nominal current: 41 A, Nom. voltage: 1000 V, Pitch: 7.5 mm, Number of positions: 7, Connection method: Spring-cage connection, Mounting: Soldering, Conductor/PCB connection direction: 0 °, Color: green



The figure shows a 5-pos. version of the product

Product Features

- ✓ Fast connection technology thanks to tool-free direct plug-in principle
- ✓ Conductor connection direction: horizontal (0° -H) to the PCB
- ✓ Unlimited 600 V UL approval thanks to compact zigzag pinning
- ✓ Single-position terminal block bases with double pin
- ✓ SPT 5 Push-in spring-cage PCB terminal blocks for conductor cross sections up to 6 mm², stranded



Key commercial data

| | |
|--------------------------------------|-----------|
| Packing unit | 1 pc |
| Minimum order quantity | 50 pc |
| Weight per Piece (excluding packing) | 25.98 GRM |
| Custom tariff number | 85369010 |
| Country of origin | Bulgaria |

Technical data

Dimensions

| | |
|----------------|-----------|
| Pitch | 7.5 mm |
| Dimension a | 45 mm |
| Pin dimensions | 1,7 x 0,8 |
| Pin spacing | 13.2 mm |
| Hole diameter | 2.1 mm |

General

| | |
|-------------------|-------------|
| Range of articles | SPT 5/...-H |
|-------------------|-------------|

PCB terminal block - SPT 5/ 7-H-7,5-ZB - 1719244

Technical data

General

| | |
|---|-------------------|
| Insulating material group | I |
| Rated surge voltage (III/3) | 8 kV |
| Rated surge voltage (III/2) | 8 kV |
| Rated surge voltage (II/2) | 6 kV |
| Rated voltage (III/3) | 800 V |
| Rated voltage (III/2) | 1000 V |
| Rated voltage (II/2) | 1000 V |
| Connection in acc. with standard | EN-VDE |
| Nominal current I_N | 41 A |
| Nominal cross section | 6 mm ² |
| Insulating material | PA |
| Solder pin surface | Sn |
| Inflammability class according to UL 94 | V0 |
| Stripping length | 15 mm |
| Number of positions | 7 |

Connection data

| | |
|---|----------------------|
| Conductor cross section solid min. | 0.2 mm ² |
| Conductor cross section solid max. | 10 mm ² |
| Conductor cross section stranded min. | 0.2 mm ² |
| Conductor cross section stranded max. | 6 mm ² |
| Conductor cross section stranded, with ferrule without plastic sleeve min. | 0.25 mm ² |
| Conductor cross section stranded, with ferrule without plastic sleeve max. | 6 mm ² |
| Conductor cross section stranded, with ferrule with plastic sleeve min. | 0.25 mm ² |
| Conductor cross section stranded, with ferrule with plastic sleeve max. | 4 mm ² |
| Conductor cross section AWG/kcmil min. | 24 |
| Conductor cross section AWG/kcmil max | 8 |
| 2 conductors with same cross section, stranded, TWIN ferrules with plastic sleeve, min. | 0.25 mm ² |
| 2 conductors with same cross section, stranded, TWIN ferrules with plastic sleeve, max. | 1.5 mm ² |
| Minimum AWG according to UL/CUL | 24 |
| Maximum AWG according to UL/CUL | 8 |

Classifications

eCl@ss

| | |
|------------|----------|
| eCl@ss 4.0 | 27141109 |
|------------|----------|

PCB terminal block - SPT 5/ 7-H-7,5-ZB - 1719244

Classifications

eCl@ss

| | |
|------------|----------|
| eCl@ss 4.1 | 27141109 |
| eCl@ss 5.0 | 27141190 |
| eCl@ss 5.1 | 27141190 |
| eCl@ss 6.0 | 27261101 |
| eCl@ss 7.0 | 27440401 |
| eCl@ss 8.0 | 27440401 |

ETIM

| | |
|----------|----------|
| ETIM 3.0 | EC001121 |
| ETIM 4.0 | EC002643 |
| ETIM 5.0 | EC002643 |

UNSPSC

| | |
|---------------|----------|
| UNSPSC 6.01 | 30211801 |
| UNSPSC 7.0901 | 39121432 |
| UNSPSC 11 | 39121432 |
| UNSPSC 12.01 | 39121432 |
| UNSPSC 13.2 | 39121432 |

Approvals

Approvals

Approvals

UL Recognized / SEV / cUL Recognized / CCA / IECCEB Scheme / GOST / UL Recognized / cUL Recognized / GOST / cULus Recognized

Ex Approvals

Approvals submitted

Approval details

PCB terminal block - SPT 5/ 7-H-7,5-ZB - 1719244

Approvals

| | | |
|---|-------|-------|
| UL Recognized  | | |
| | B | C |
| mm ² /AWG/kcmil | 24-8 | 24-8 |
| Nominal current I _N | 36 A | 36 A |
| Nominal voltage U _N | 600 V | 600 V |

| | |
|--------------------------------|--------|
| SEV | |
| | |
| mm ² /AWG/kcmil | 6 |
| Nominal current I _N | 41 A |
| Nominal voltage U _N | 1000 V |

| | | |
|--|-------|-------|
| cUL Recognized  | | |
| | B | C |
| mm ² /AWG/kcmil | 24-8 | 24-8 |
| Nominal current I _N | 36 A | 36 A |
| Nominal voltage U _N | 600 V | 600 V |

| | |
|--------------------------------|--------|
| CCA | |
| | |
| mm ² /AWG/kcmil | 6 |
| Nominal current I _N | 41 A |
| Nominal voltage U _N | 1000 V |

| | |
|---|--------|
| IECEE CB Scheme  | |
| | |
| mm ² /AWG/kcmil | 6 |
| Nominal current I _N | 41 A |
| Nominal voltage U _N | 1000 V |

PCB terminal block - SPT 5/ 7-H-7,5-ZB - 1719244

Approvals

GOST

UL Recognized

| | B | C |
|--------------------------------|-------|-------|
| mm ² /AWG/kcmil | 24-8 | 24-8 |
| Nominal current I _N | 36 A | 36 A |
| Nominal voltage U _N | 600 V | 600 V |

cUL Recognized

| | B | C |
|--------------------------------|-------|-------|
| mm ² /AWG/kcmil | 24-8 | 24-8 |
| Nominal current I _N | 36 A | 36 A |
| Nominal voltage U _N | 600 V | 600 V |

GOST

cULus Recognized

Drawings

Drilling diagram

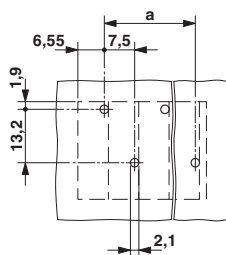

Diagram

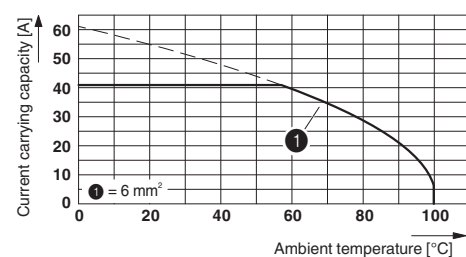

PCB terminal block - SPT 5/ 7-H-7,5-ZB - 1719244

Dimensioned drawing

