

PART NUMBER	REV	FIRST USED
687395-5	AF	565435-5

THIS DRAWING IS A CONTROLLED DOCUMENT.

LOC A
DIST 66

TERMINAL NAME: .250 FLAG FASTON				
TE P/N	MFG P/N	.018 STK	.018 STK	.016 STK
1949687	SFO-61T-250A	60645	141697	63604
		41531	61156	42511
		41532	63517	42742
		41799	63555	60641
		41800	63651	60712
		41801	100646	63445
		41802		150561
		42041		
		150560		STEEL
				42404
				1742460
TERM APPL SPEC 114-2078				

CRIMPING DATA			
PAD LTR	CRIMP HEIGHT	WIRE SIZE	
A	.070 ±.002	12	
B	.060 ±.002	14	
C	.052 ±.002	16	
D	.048 ±.002	18	
CRIMP	SIZE	TYPE	RANGE
WIRE	.160	TAB LOCK	18-12
INSUL	.180	0	.110-.210
FEED	APPL INST	SET UP GAGE	LAYOUT
.767	AI 8037	-	-
WIRE STRIP LENGTH .205-.235			

-5 BENCH MODEL K AIR FEED

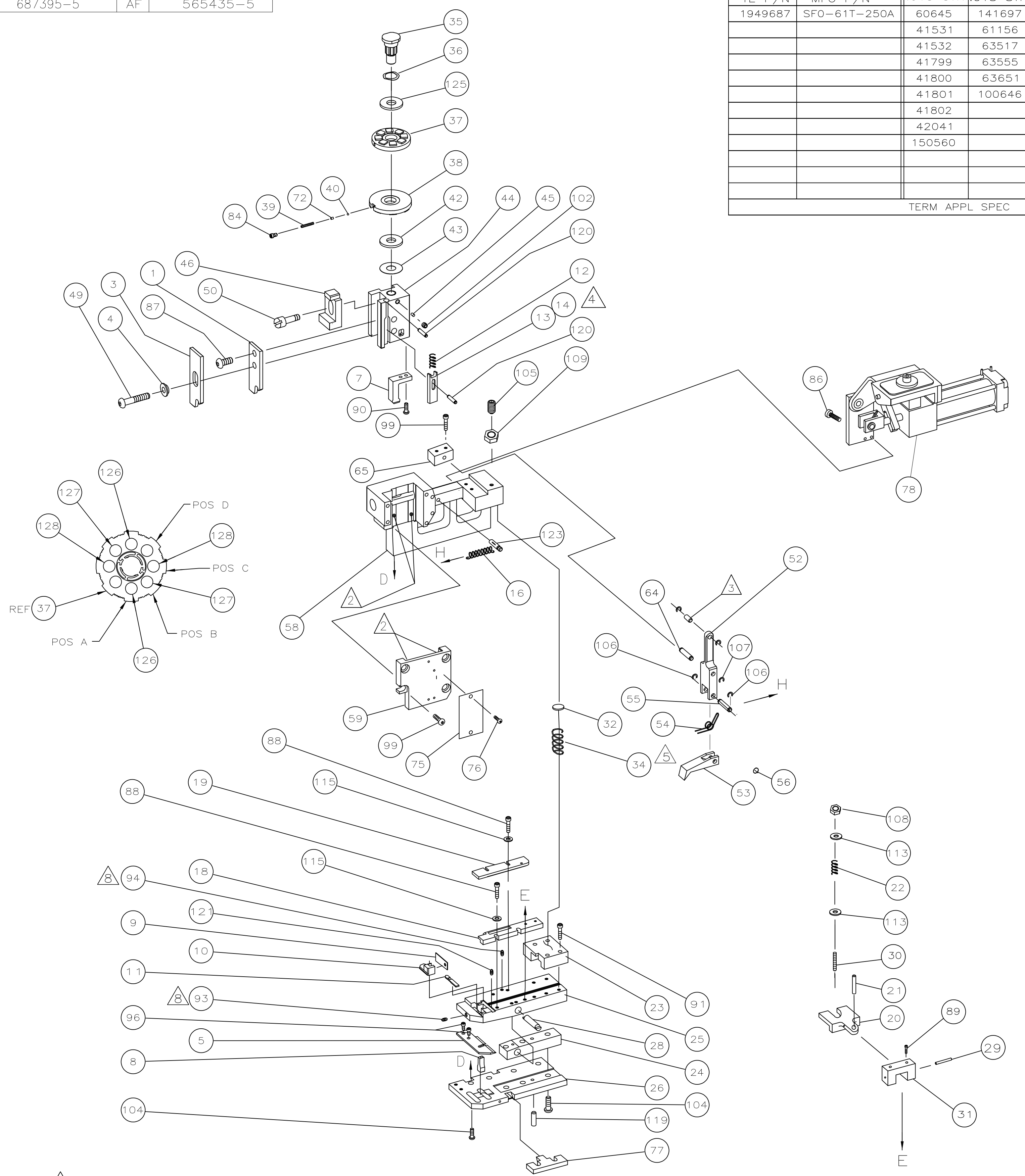

- 1 RECOMMENDED SPARE PARTS.
- 2 GREASE LIGHTLY.
- 3 LUBRICATE DAILY USING NO. 20 MACHINE OIL.
- 4 CHANGE TERMINAL POSITIONER AS REQUIRED TO KEEP TERMINAL ON CENTER OF ANVIL.FASTEN EXTRA TERMINAL POSITIONER TO APPLICATOR.
- 5 AFTER ASSEMBLY OF APPLICATOR, PROPER SPRING PRESSURE (ITEM 34) CAN BE OBTAINED BY TIGHTENING SET SCREW (ITEM 105) UNTIL CONTACT IS MADE WITH SPACER (ITEM 32) THEN TIGHTEN AN ADDITIONAL 5 1/2 - 6 REVOLUTIONS.
- 6 ITEMS NOT SHOWN.
- 7 TO BE SHIPPED WITH ASSEMBLY.
- 8 APPLY LOCTITE TO ITEM 93 AT ASSEMBLY.
- 9 SPARE TOOLING KIT 7-687395-7.

2	-	5-354779-3	PIN, WIRE DISC (.3255)D	129
2	-	4-354779-7	PIN, WIRE DISC (.3225)C	128
2	-	3-354779-0	PIN, WIRE DISC (.3140)B	127
2	-	1-354779-3	PIN, WIRE DISC (.3055)A	126
1	-	986950-1	WASHER, FLAT PRECISION	125
				124
1	-	3-22183-9	PIN, GROOVED Ø.188X1.25	123
				122
1	-	3-21028-2	PIN, SLOTTED SPRING (Ø.094X.25)	121
2	-	4-21028-9	PIN, SLOTTED SPRING (Ø.125X.38)	120
1	-	21029-5	PIN,SLOTTED SPRING (Ø.188X.75)	119
				118
				117
				116
4	-	21024-4	WASHER, LOCK (#8)	115
				114
2	-	21899-2	WASHER,FLAT (#10)	113
				112
				111
				110
1	-	1-22202-7	NUT, HEX (5/16-24)	109
1	-	21022-3	NUT,HEX (LOCKING) (10-32)	108
1	-	1-21986-2	RING,RET "E" Ø3/16	107
2	-	21045-3	RING,RET "C" Ø3/16	106
1	-	8-21007-5	SCREW,SKT SET(5/16-24x.75)	105
7	-	2-22733-8	SCREW, BHC (1/4-20X.63)	104
				103
1	-	21009-2	SCREW,SKT SET(1/4-20x.25)	102
				101
				100
6	-	3-21000-8	SCREW, SHC (10-32X.88)	99
				98
				97
2	-	7-21000-6	SCREW, SHC (10-32X.38)	96
				95
1	-	4-21006-5	SCR,SET NYLOCK (8-32X.62)	94
1	-	21061-9	SCREW, SKT SET (8-32X.25)	93
				92
4	-	2-21000-9	SCREW, SHC (8-32X.75)	91
2	-	1-23030-1	SCREW, SHC (NYLOK)(8-32X.62)	90
2	-	2-21000-8	SCREW, SHC (8-32X.62)	89
4	-	2-22603-3	SCREW, HEX (8-32X.50)	88
1	-	2-21002-1	SCREW, BHC (8-32X.38)	87
2	-	21001-3	SCREW,SHC (1/4-20X.62)	86
				85
1	-	23030-1	SCREW, SHC(NYLOK)(6-32X.25)	84
				83
				82
				81
6	-	457244-2	GUARD ASSEMBLY	80
				79
1	-	457098-1	AIR FEED ASSEMBLY	78
1	-	694427-1	PLATE, APPL MNT	77
2	-	21017-2	SCR,DRIVE(#2X.19)ID	76
1	-	461264-1	PLATE, IDENTIFICATION	75
				74
				73
1	-	690603-1	SPRING, ASSIST	72
				71
				70
				69
				68
				67
				66
				65
				64
				63
				62
				61
				60
				59
				58
				57
				56
				55
				54
				53
				52
				51
				50
				49
				48
				47
				46
				45
				44
				43
				42
				41
				40
				39
				38
				37
				36
				35
				34
				33
				32
				31
				30
				29
				28
				27
				26
				25
				24
				23
				22
				21
				20
				19
				18
				17
				16
				15
				14
				13
				12
				11
				10
				9
				8
				7
				6
				5
				4
				3
				2
				1

QTY	U/M	PART NO	DESCRIPTION	ITEM NO
				70
				69
				68
				67
				66
				65
				64
				63
				62
				61
				60
				59
				58
				57
				56
				55
				54
				53
				52
				51
				50
				49
				48
				47
				46
				45
				44
				43
				42
				41
				40
				39
				38
				37
				36
				35
				34
				33
				32
				31
				30
				29
				28
				27
				26
				25
				24
				23
				22
				21
				20
				19
				18
				17
				16
				15
				14
				13
				12
				11
				10
				9
				8
				7
				6
				5
				4
				3
				2
				1

P	LTR	REVISION RECORD	DATE	OWN	APVD
AF	ECR-14-004490		3-2014	JH	UG
AE	ECR-14-002720		2-2014	JH	UG
AD	ECR-018324		11-2013	XZ	GB

DIMENSIONS:	TOLERANCES UNLESS OTHERWISE SPECIFIED:
INCHES	0 PLC ±.0005
	1 PLC ±.0010
	2 PLC ±.0015
	3 PLC ±.0020
	4 PLC ±.0025
ANGLES:	
SURFACE TEXTURE:	√

DRAWN	D.SALTZER	6-3-94	MATERIAL	-	HEAT TREAT	-
CHK	C.ERISMAN	6-3-94				
APVD	T.BEDDICK	6-3-94				
NAME: END FEED HINGE BAR APPLICATOR						
SCALE	SIZE	DRAWING NO	SHEET	OF	REV	
NTS	A1	687395-5	1	1	AF	

CUSTOMER ACCESSIBLE PRODUCTION DRAWING