

REV.	EQV. NO.	MODIFY. CONTENT	DATE
X1		新增規格	3/16/06
X2		更改磁盤電線規格	7/27/06
A	ES.D0003.003	暫行版轉正式版	3/17/07

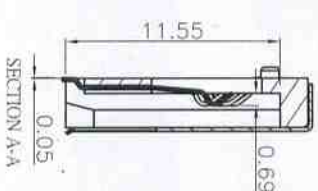

XD DEFINITION

PN NO.	FUNCTION
1/9	CMO/CARD DETECT
2	REMOV/REASY
3	READ ENABLE
4	CARD ENABLE
5	COMMAND LATCH ENABLE
6	ADDRESS LATCH ENABLE
7	WRITE ENABLE
8	WRITE PROTECT
9	CMO
10	DATA0
11	DATA1
12	DATA2
13	DATA3
14	DATA4
15	DATA5
16	DATA6
17	DATA7
18/20	VCC

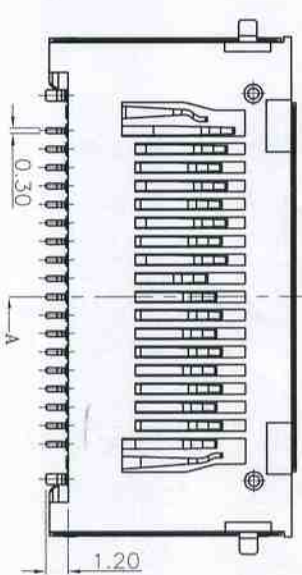
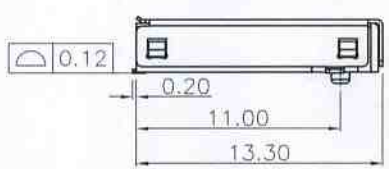
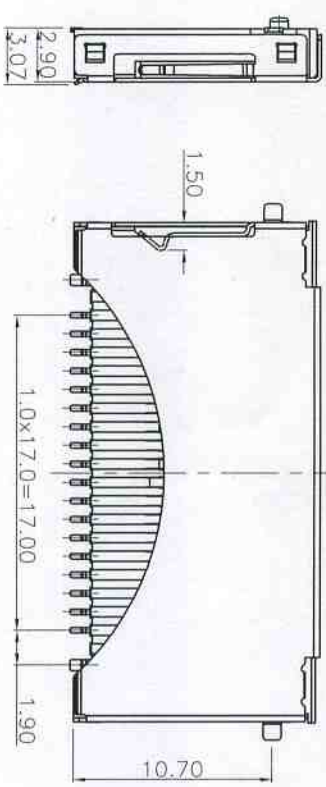
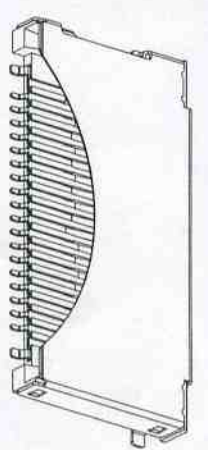
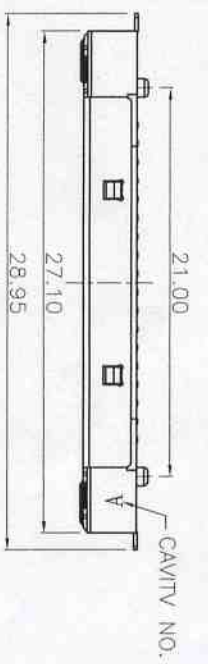
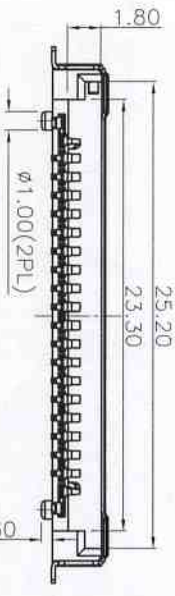

THE PART NUMBER:
101-00158-**

- 29 功能區鍍金1u", 錫腳鍍亮地鍍至少 160u"
- 30 功能區鍍金3u", 錫腳鍍亮地鍍至少 160u"
- 31 功能區鍍金5u", 錫腳鍍亮地鍍至少 160u"
- 32 功能區鍍金10u", 錫腳鍍亮地鍍至少 160u"
- 33 功能區鍍金15u", 錫腳鍍亮地鍍至少 160u"
- 34 功能區鍍金30u", 錫腳鍍亮地鍍至少 160u"
- 64 功能區鍍金1u", 錫腳鍍亮地鍍至少 160u"
- 65 功能區鍍金1u", 錫腳鍍亮地鍍至少 160u"
- 66 功能區鍍金5u", 錫腳鍍亮地鍍至少 160u"
- 67 功能區鍍金10u", 錫腳鍍亮地鍍至少 160u"
- 68 功能區鍍金15u", 錫腳鍍亮地鍍至少 160u"
- 69 功能區鍍金30u", 錫腳鍍亮地鍍至少 160u"

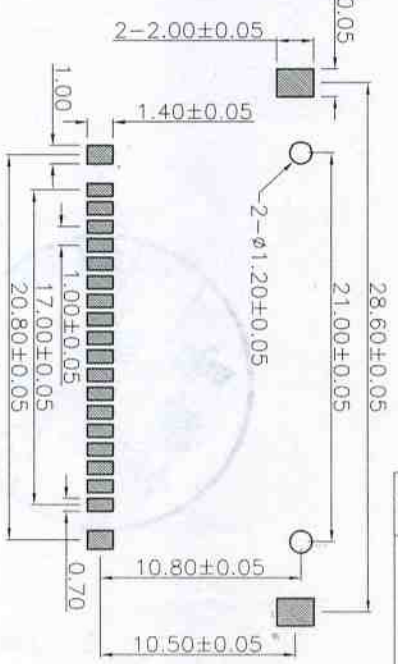

MATERIALS & PLATINGS TABLE

ITEM	DESCRIPTION	QTY	MATERIAL	FINISH
③	SHELL	1	STAINLESS STEEL	t=0.20±0.02mm
②	TER	1	PHOSPHER	SELECTIVE GOLD 1-30u" ON CONTACT AREA TIN PLATED (160 u") ON SOLDER AREA
①	HOUSING	1	LOP	LOP, 30% G/F, UL 94V-0, COLOR: BLACK

- NOTE:**
- 1.0 MECHANICAL CHARACTERISTICS**
- 2.1 Insertion Force: 9.8 N (MAX)
 - 2.2 Extraction Force: 1.47 N (MIN)
 - 2.3 Mating cycle: 10000 cycles
- 2.0 ELECTRICAL CHARACTERISTICS**
- 3.1 Current rating : 0.5 A
 - 3.2 Operating voltage : 3.3V
 - 3.3 Contact resistance: 40m ohms max.
 - 3.4 Insulation resistance: 1000M ohms min. at 500 VDC
 - 3.5 Dielectric withstanding voltage: 250 VAC/1minute
 - 3.6 Operating Temperature: -0°C~+55°C
 - 3.7 Storage Temperature: -20°C~+65°C
 - 3.8 Operation/Storage humidity: 95% or less

GENERAL	TOLERANCE	FILE NO.	PART NO.	DRAWN	LZH	MATERIAL	SCALE	NO SCALE
x.±0.50	x.±1.5*	101-00158	101-00158-**					
x.±0.38	x.±2*	REV. A	TITLE XD NO PUSH CONN.-I	CHECKED	楊奎奎 3/16/07	DATE 3/17/07	UNIT	mm
xx±0.25	xx±1*	SIZE A4	SHEET 1/1	APPROVED	Jeffrey SM	Shouh Min Industry (ShenZhen)CO.,LTD		