

IEC Appliance Outlet D, insert Mounting, Solder Terminal



**Description**

- 1 Function :
- Connector , Pin temperature 70 °C , Protection class II
- Solder terminal

**Other versions on request**

- For protection class II

**Weblinks**

[pdf datasheet](#), [html-datasheet](#), [General Product Information](#), [RoHS](#), [CHINA-RoHS](#), [REACH](#), [Distributor-Stock-Check](#), [Accessories](#), [Detailed request for product](#)

**Approvals**

- VDE Certificate Number: 40011945
- UL File Number: E45115
- CSA File Number: 27324

**Technical Data**

Ratings IEC	2.5 A / 250 VAC; 50 Hz
Ratings UL/CSA	4 A / 250 VAC; 60 Hz
Dielectric Strength	> 4 kVAC between L-N > 2 kVAC between L/N-PE (1 min/50 Hz)
Allowable Operation Temperature	-25 °C to 70 °C
IP-Protection	from front side IP 20 acc. to IEC 60529
Insulation cover	Suitable for appliances with protection class II acc. to IEC 61140
Terminal	Solder terminal straight
Material: Housing	PA6, black or grey, UL 94V-0

Detailed information on product approvals, code requirements, usage instructions and detailed test conditions can be looked up in [General Product Information](#)

**Dimensions**

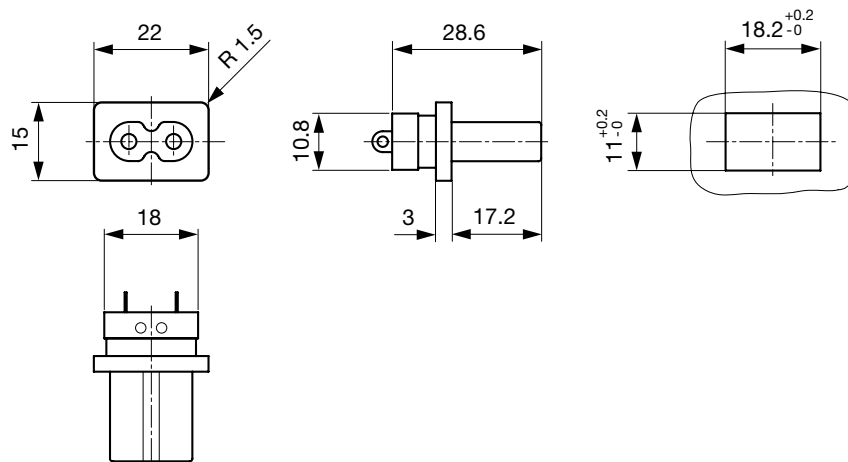

Length of the terminal please find at the order code configuration table

**Config. Code**

5086 - H - A B C 0 - D - E O

The characters are placeholders for the correspondingly keys of selections from the key tables.

5086 - **H** - A B C 0 - D - E O = **Type**

Type	Configuration key
protection class II	X

5086 - H - **A** B C 0 - D - E O = **Terminals**

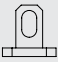
Terminal L	Configuration key
solder terminal 	1

5086 - H - A **B** C 0 - D - E O = **Terminals**

Terminal N	Configuration key
solder terminal	1

Symbols similar as in table A

5086 - H - A B **C** 0 - D - E O = **Terminals**

Terminal Ground	Configuration key
without terminal	0

Symbols similar as in table A

5086 - H - A B C 0 - **D** - E O = **Color**

Color	Configuration key
Black	A
Grey	B

5086 - H - A B C 0 - D - **E** O = **Style**

Style	Configuration key
insert type	5

5086 - H - A B C 0 - D - E - **O** = **Features**

Features	Configuration key

**All Variants**

Terminals L / N	Color	Style	Config. Code	Order Number
solder terminal	Black	insert type	5086-X-1100-A-5	6180.0006

The listet variants should be available from stock Other versions on request [www.schurter.com/contact](http://www.schurter.com/contact)

Availability for all products can be searched real-time:<http://www.schurter.com/en/Stock-Check/Stock-Check-SCHURTER>

**Packaging unit** 50 Pcs

**Accessories**

**Description**



**Wire Harness**  
Wire harness for SCHURTER products