

THIS DRAWING IS UNPUBLISHED.

RELEASED FOR PUBLICATION

© COPYRIGHT 20

ALL RIGHTS RESERVED.

LOC	DIST	REVISIONS					
		P	LTR	DESCRIPTION	DATE	DWN	APVD
-	00		E	PER ECR-12-003178	04JUN12	AZ	AC
			F	REVISED PER ECR-13-019886	24DEC2013	FL	FY
			-	-	-	-	-
			-	-	-	-	-

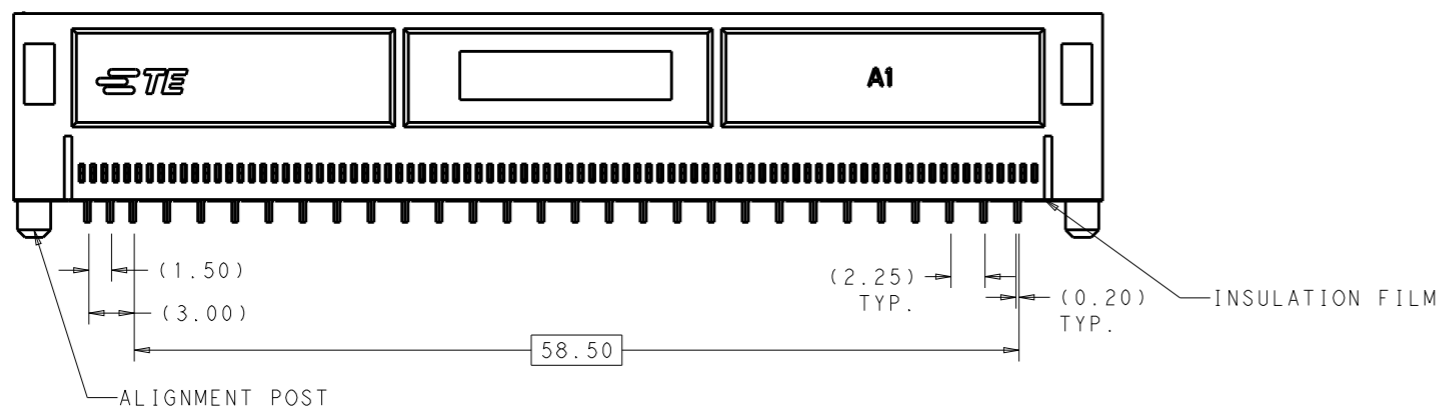
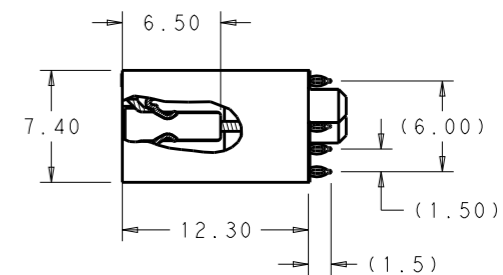
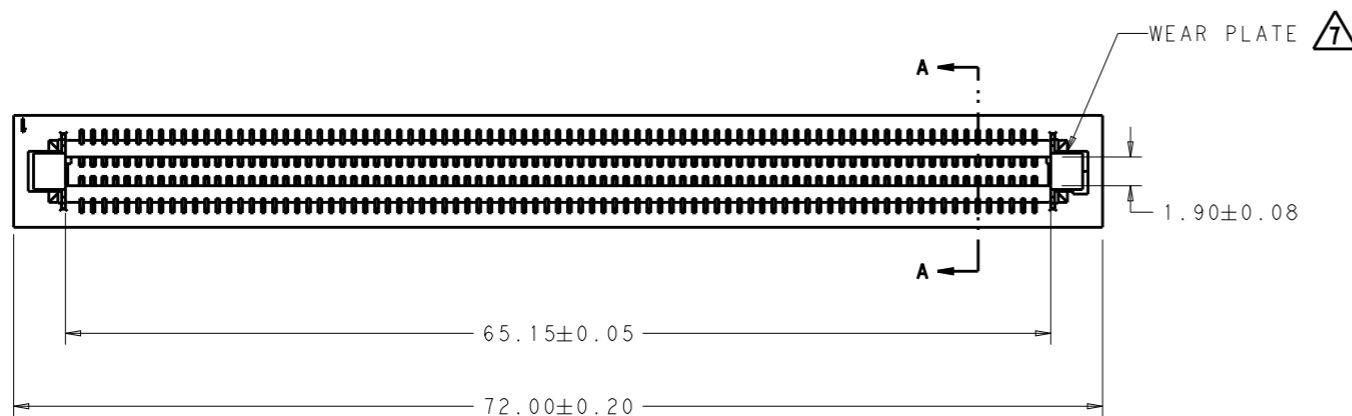

YES	1-1932632-2
NO	1-1932632-1
INSULATION FILM	PART NUMBER

THIS DRAWING IS A CONTROLLED DOCUMENT.		DWN	JEFF GONG	26-Oct-10	<b>STE</b> TE Connectivity								
DIMENSIONS: mm		CHK	ALEX SHOAT	27-Oct-10									
TOLERANCES UNLESS OTHERWISE SPECIFIED:		APVD	MANQIAN WANG	27-Oct-10									
<ul style="list-style-type: none"> <li>0 PLC ±-</li> <li>1 PLC ±0.5</li> <li>2 PLC ±0.25</li> <li>3 PLC ±-</li> <li>4 PLC ±-</li> <li>ANGLES ±3°</li> </ul>		PRODUCT SPEC	108-60091	NAME		CARD EDGE CONNECTOR, VERTICAL ENHANCED MICRO TCA							
MATERIAL	-	FINISH	-	APPLICATION SPEC	114-	SIZE	A3	CAGE CODE	00779	DRAWING NO	1932632	RESTRICTED TO	-
				CUSTOMER DRAWING		SCALE	N/A	SHEET	1	OF	2	REV	F

THIS DRAWING IS UNPUBLISHED. RELEASED FOR PUBLICATION  
 © COPYRIGHT 20 ALL RIGHTS RESERVED.

LOC	DIST	REVISIONS			
P	LTR	DESCRIPTION	DATE	DWN	APVD
-	00	SEE SHEET 1	-	-	-

- NOTES, UNLESS OTHERWISE SPECIFIED:
- ⚠ MATERIAL:  
HOUSING- LCP, UL94-0 RATED, BLACK.  
CONTACTS- PHOSPHOR BRONZE  
WEAR PLATE- STAINLESS STEEL
  - ⚠ RECOMMENDED PCB HOLE DIMENSIONS;  
DRILLED HOLE: 0.64±0.02mm.  
FINISHED HOLE: 0.55mm REF  
Cu THICKNESS: 25-50um WITH EITHER PLATING THICKNESS
    - 1). HASL Sn Pb: 4-10um.
    - 2). IMMERSION Sn: MIN 0.5um
    - 3). OSP: 0.2~0.5um
    - 4). IMMERSION Au/Ni: 0.5~1.2um Au OVER 3.0~7.0um Ni
    - 5). IMMERSION Ag: 0.1um MIN
  - ⚠ FINISH:
    - 1). MATING AREA: 0.76um MIN GOLD OR 0.64um MIN PALLADIUM-NICKEL OVER 1.27um NICKEL
    - 2). COMPLIANT PIN AREA: 0.5um MATTE TIN OVER 1.27um NICKEL.
  - 4. CONNECTOR MARKED WITH PART NUMBER AND DATE CODE.
  - 5. CONTACT AREA LUBRICATED WITH BELLCORE APPROVED LUBRICANT. TECHNICAL REFERENCE GR1217-CORE ISSUE I, NOVEMBER 1995.
  - 6. REFER TO TYCO ELECTRONICS APPLICATION SPECIFICATION 114-13180 FOR SPECIFIC APPLICATION RELATED INFORMATION
  - ⚠ WEAR PLATE EXTENDE FROM TOP OF CONNECTOR TO BOTTOM OF SLOT AND IS USED TO ELIMINATE WEAR OF THE HOUSING CAUSED BY THE EDGE OF THE PCB CARD.
  - 8. INSULATION FILM USED WHEN ADDITIONAL INSULATION SPACING IS NEEDED BETWEEN PCB TRACES AND CONTACTS.

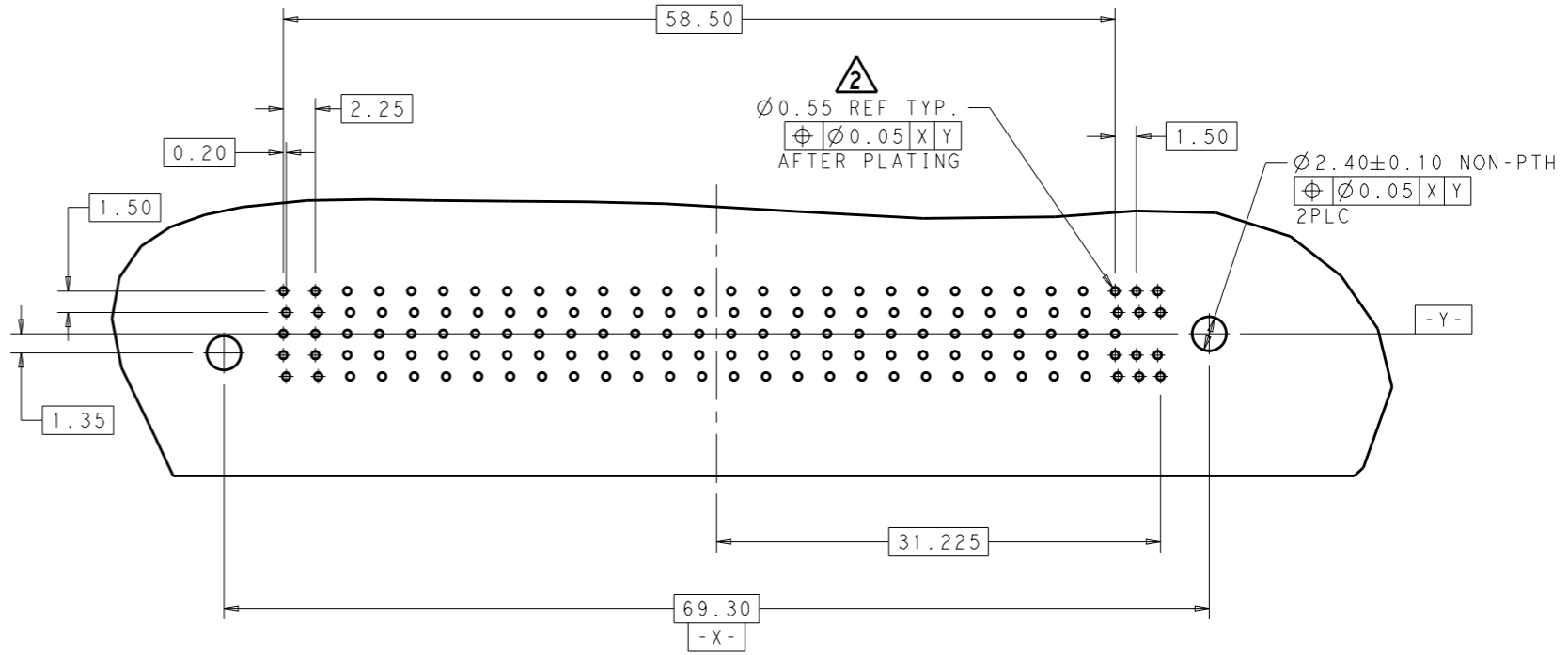

THIS DRAWING IS A CONTROLLED DOCUMENT.		DWN	JEFF GONG	26-Oct-10	<b>STE</b> TE Connectivity
DIMENSIONS: mm		CHK	ALEX SHOAT	27-Oct-10	
TOLERANCES UNLESS OTHERWISE SPECIFIED:		APVD	MANQIAN WANG	27-Oct-10	
0 PLC ±- 1 PLC ±0.5 2 PLC ±0.25 3 PLC ±- 4 PLC ±- ANGLES ±3°		PRODUCT SPEC	NAME		
MATERIAL		APPLICATION SPEC	114-		RESTRICTED TO
FINISH		WEIGHT	-		SIZE
⚠		CUSTOMER DRAWING		SCALE	N/A
		A300779		DRAWING NO	C=1932632
		SHEET		2	OF 2
		REV		F	