

SECTION B-B
SCALE 5:1

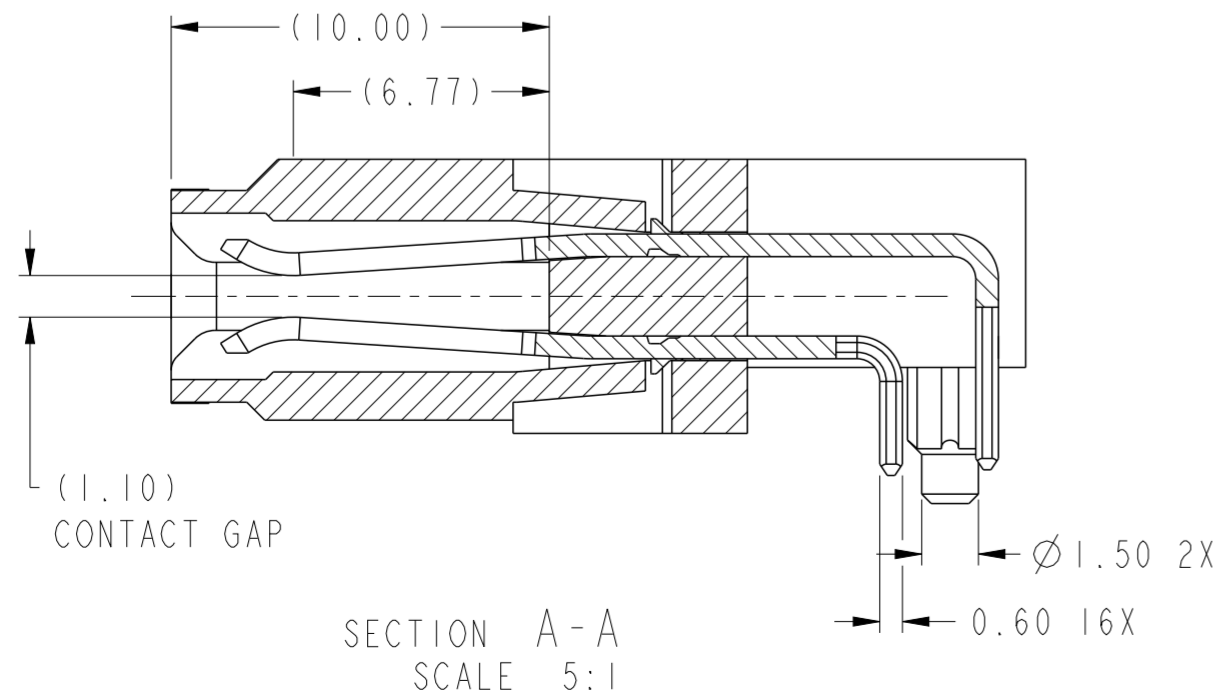
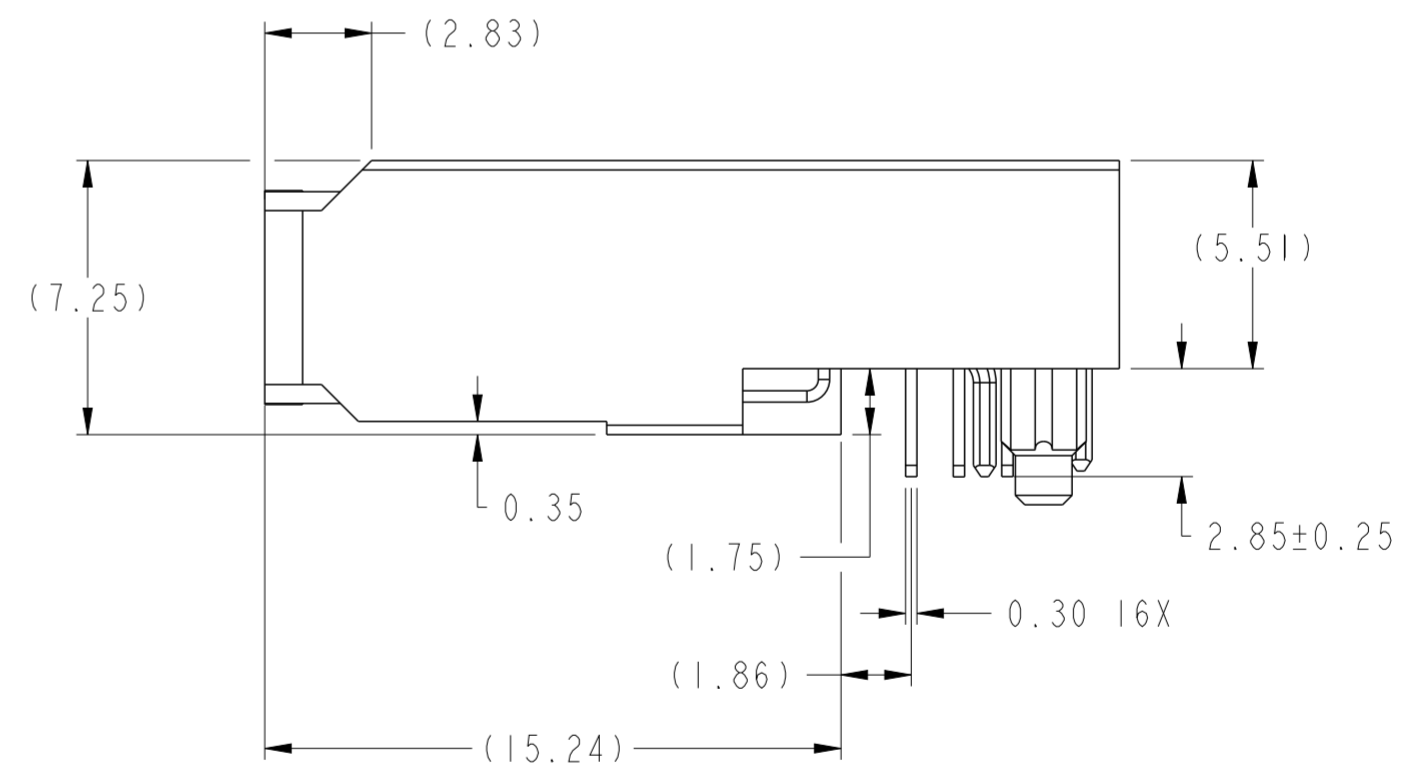
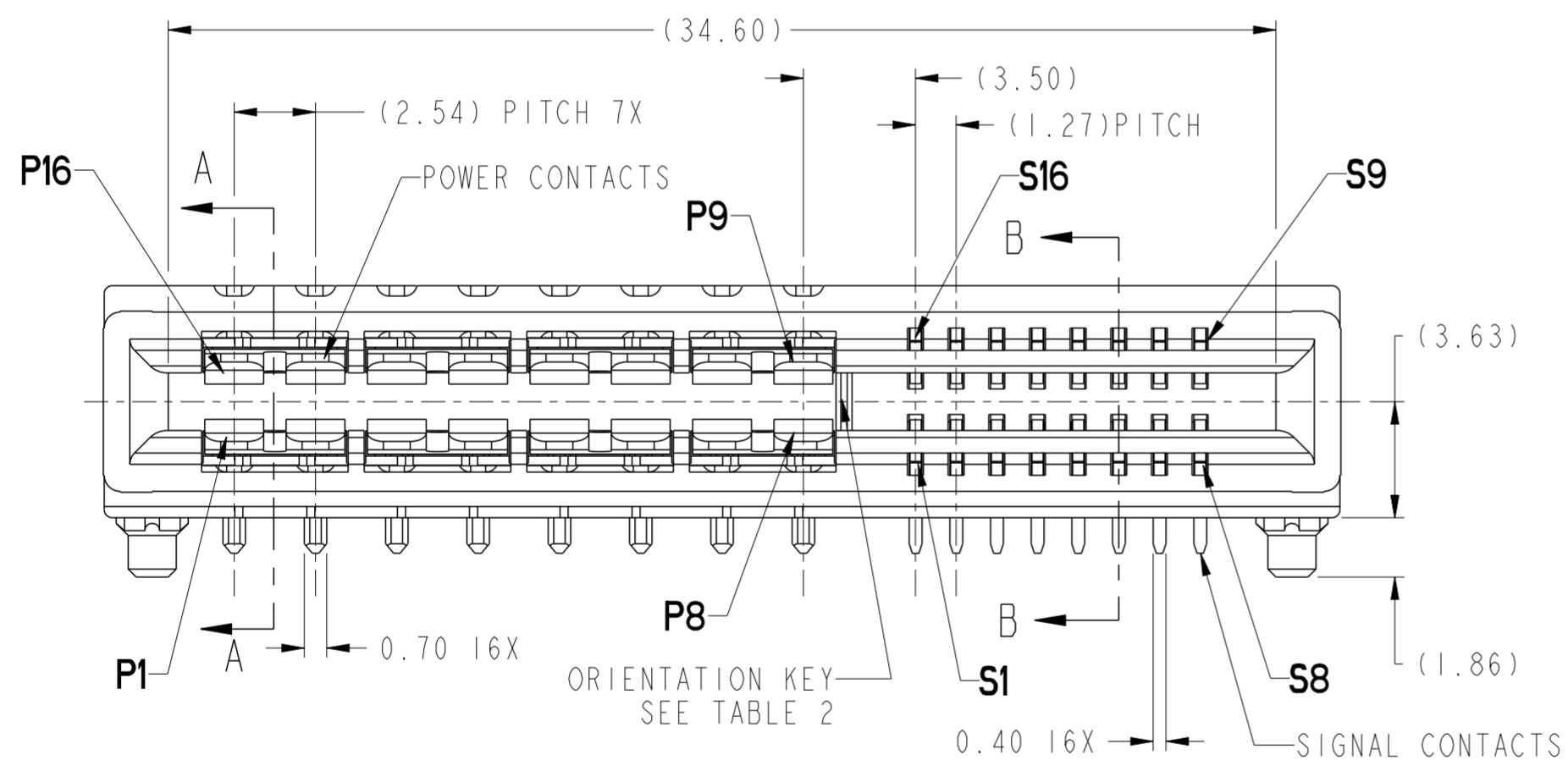

SECTION A-A
SCALE 5:1

spec ref	-	dr	Zhao Peter	2013/12/23	projection	MM	size	A2	scale	2:1
tolerance std	-	eng	Sunny2 Liu	2016/05/06			ecn no	ELX-DG-24036-1	rel level	Released
		chr	Terris Liu	2016/05/20						
		appr	Pei-Ming Zheng	2016/05/24	product family	-	rel level	Released		
surface	linear	0.X	±0.30		R/A OFFSET TYPE 16P16S		dwg no 10127949	rev C		
		0.XX	±0.25		HIGH POWER CARD EDGE					
		0.XXX	±0.15							
ASME Y14.5	angular	0°	±2°	cat. no.	-	Product - Customer Drw	sheet 1 of 4			

TABLE 1 (HPCE / SOLDER TAILS)
PLATED THROUGH-HOLE REQUIREMENTS

CONTACT TYPE	TOP LAYER DESCRIPTION	DRILLED HOLE DIAMETER	COPPER THICKNESS	TIN-LEAD THICKNESS	TIN THICKNESS	FINISHED HOLE DIAMETER
		POWER & SIGNAL	TIN-LEAD	1.10-1.16 (1.15 DRILL)	0.025 - 0.050	0.005 - 0.015
	IMMERSION TIN	1.10-1.16 (1.15 DRILL)	0.025 - 0.050	--	0.9 - 1.5um	0.94 - 1.10
	COPPER (SEE NOTE 8)	1.10-1.16 (1.15 DRILL)	0.025 - 0.050	--	--	0.94 - 1.10

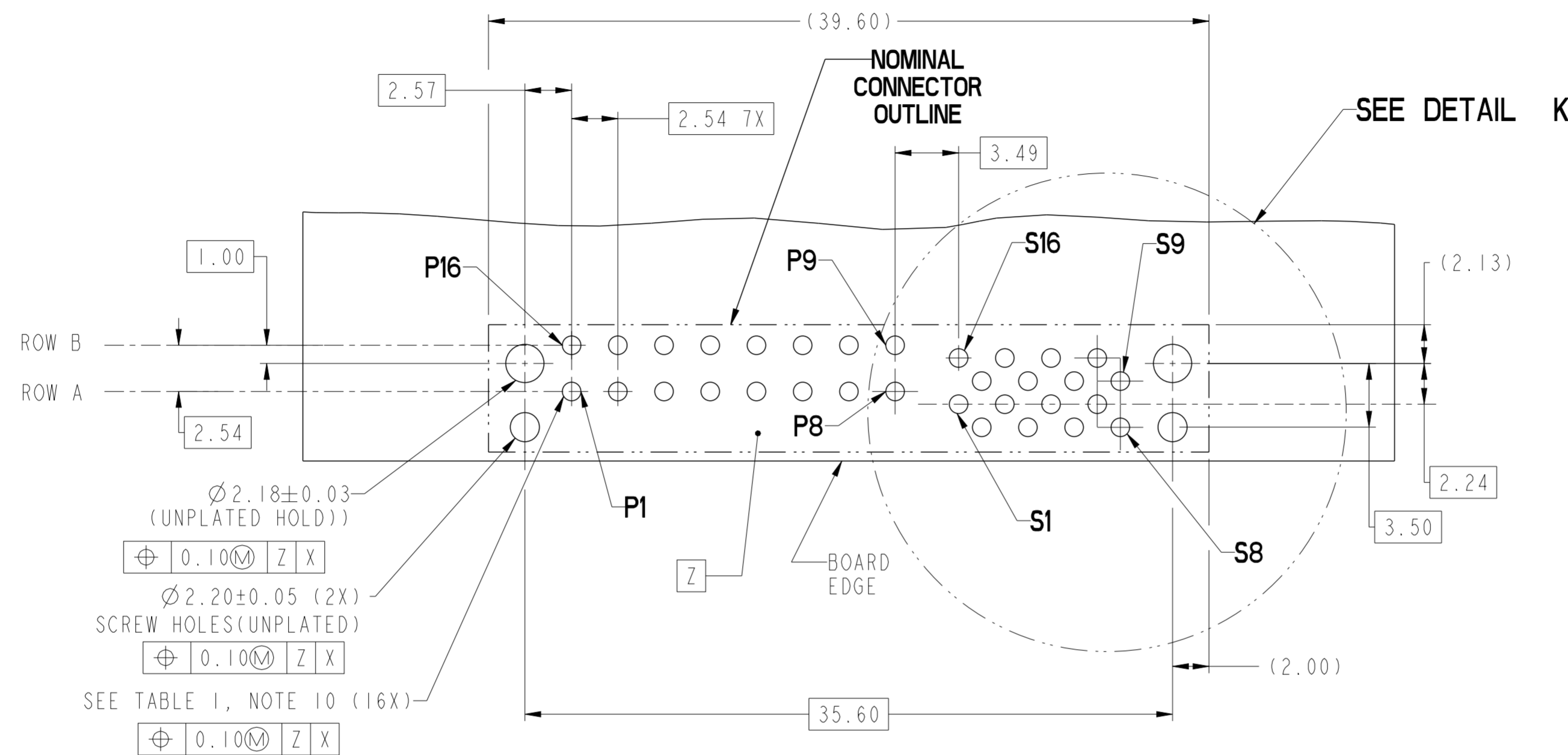

- Ø 2.18±0.03 (UNPLATED HOLD)
- ⊕ 0.10Ⓜ Z X
- Ø 2.20±0.05 (2X) SCREW HOLES (UNPLATED)
- ⊕ 0.10Ⓜ Z X
- SEE TABLE 1, NOTE 10 (16X)
- ⊕ 0.10Ⓜ Z X

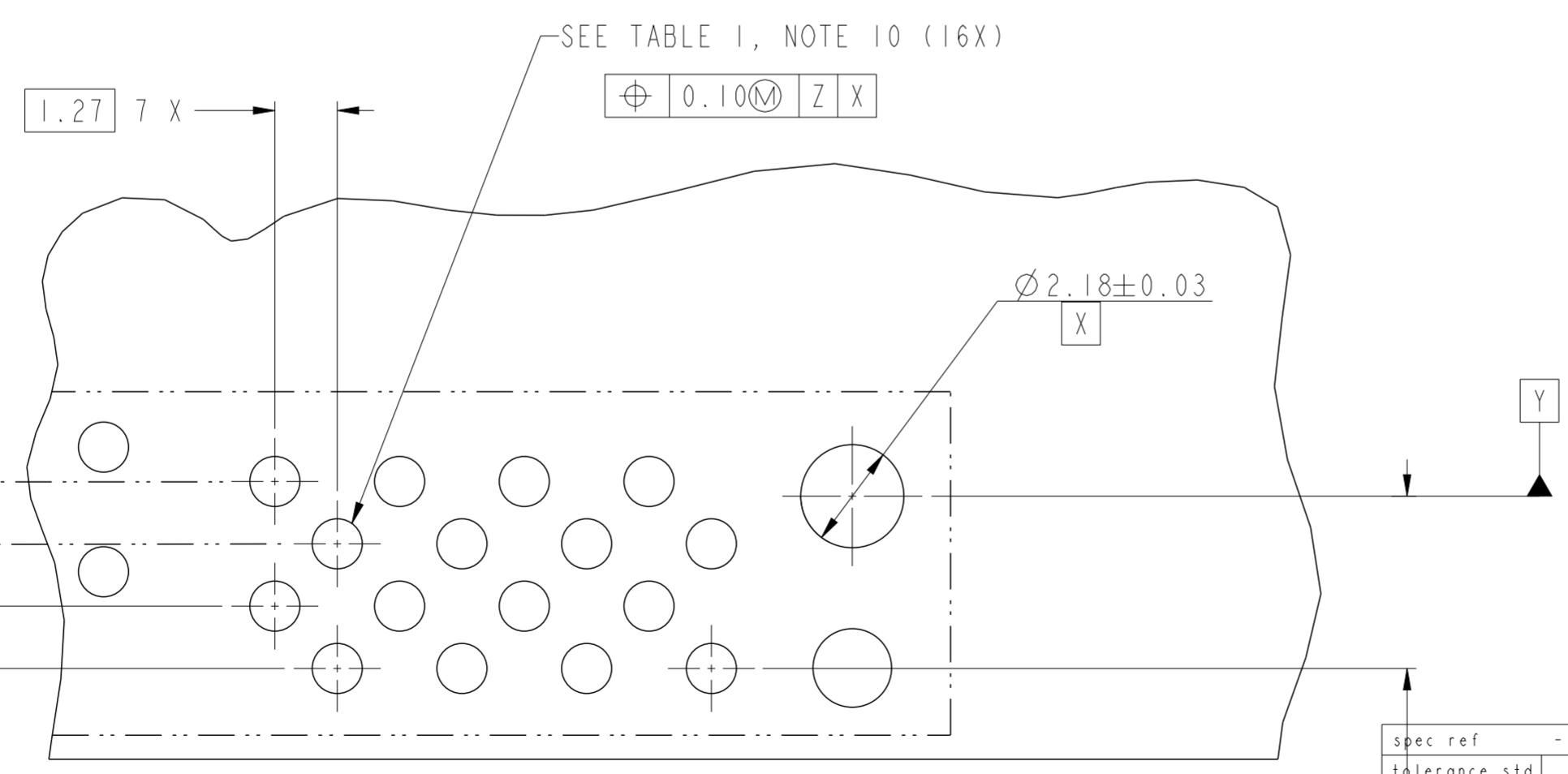

DETAIL K
SCALE 8:1

spec ref	-	dr	Zhao Peter	2013/12/23	projection	MM	size	A2	scale	4:1	
tolerance std	3.51	eng	Sunny2 Liu	2016/05/06			ecn no	ELX-DG-24036-1			
TOLERANCES UNLESS OTHERWISE SPECIFIED		chr	Terris Liu	2016/05/20			rel level	Released			
surface	ASME Y14.5	appr	Pei-Ming Zheng	2016/05/24			product family	-			
linear	0.X ±0.30 0.XX ±0.25 0.XXX ±0.15	Amphenol FCI		TITLE		R/A OFFSET TYPE 16P16S HIGH POWER CARD EDGE		dwg no	10127949		
angular	0° ±2°	cat. no.		-		Product - Customer Drw		sheet 2 of 4	rev C		

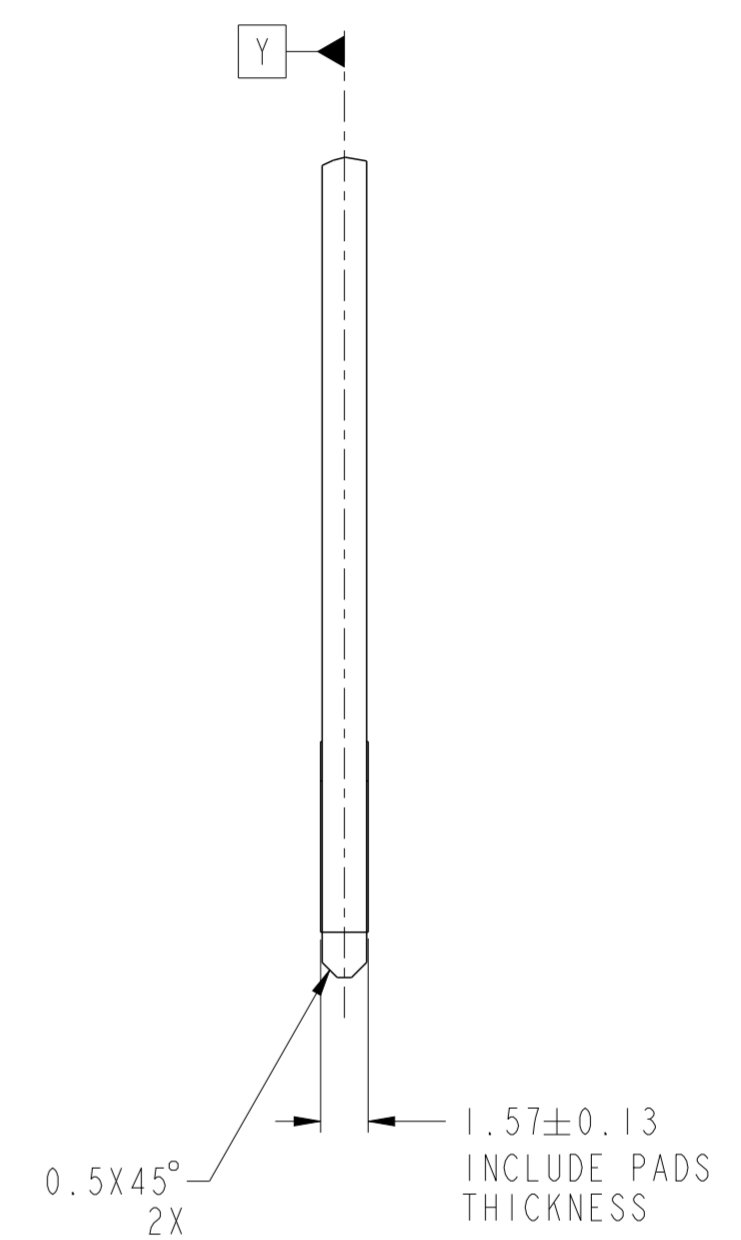
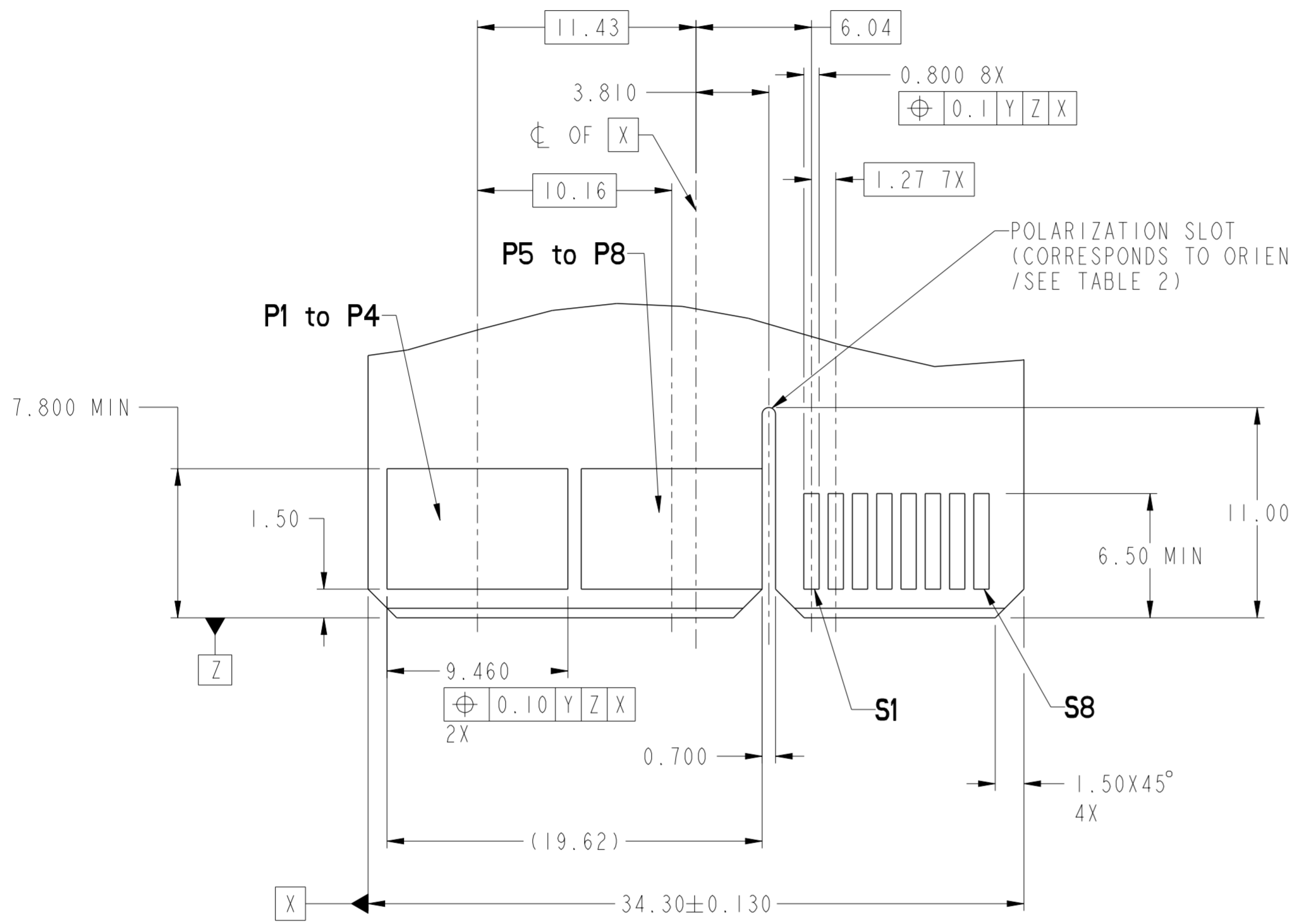

RECOMMENDED MATING BOARD FOOTPRINT

Amphenol
FCi

© 2016 AFci

spec ref	-	dr	Zhao Peter	2013/12/23	projection	MM	size	A2	scale	4:1	
tolerance std	-	eng	Sunny2 Liu	2016/05/06			ecn no	ELX-DG-24036-1	rel level	Released	
		chr	Terris Liu	2016/05/20							
		appr	Pei-Ming Zheng	2016/05/24	product family	-					
surface	ASME Y14.5	linear	0.X	±0.30		R/A OFFSET TYPE 16P16S HIGHT POWER CARD EDGE	dwg no 10127949	rev C	Product - Customer Drw		
		angular	0°	±2°					cat. no.	-	sheet 3 of 4

PDS: Rev :C

STATUS:Released

Printed: May 24, 2016

HPCE PART NUMBER (TABLE 2)				PLATING (CONTACT AREA)
10127949	TAIL TYPE	HOLD-DOWN OPTION	ORIENTATION KEY	
10127949-001LF	SOLDER TAIL	YES	YES	GXT, 0.76um
10127949-002LF			NO	GXT, 0.76um

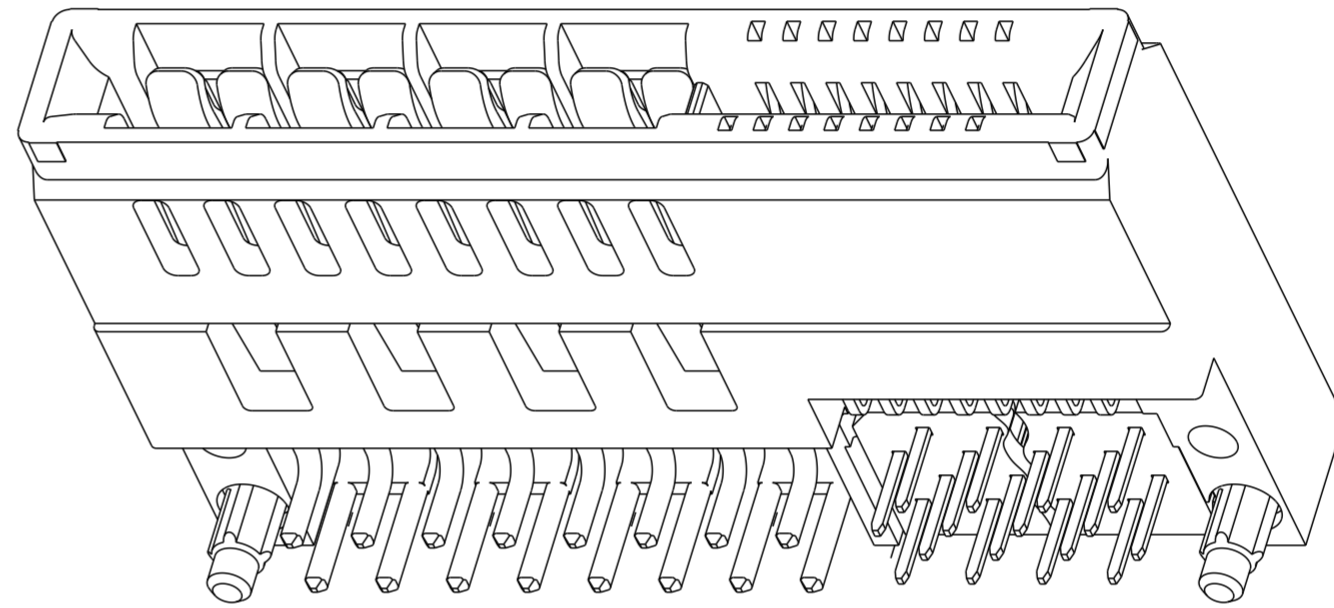

NOTES:

1. MATERIALS:
 HOUSING: HIGH TEMPERATURE THERMAL PLASTIC, BLACK, UL 94V-0
 CONTACTS: HIGH PERFORMANCE COPPER ALLOY.
2. CONTACT FINISH REF. GS-12-604 SECTION 5.2.
3. PRODUCT SPECIFICATION: GS-12-604.
4. APPLICATION SPECIFICATION: GS-20-128.
5. PRODUCT MARKING ON HOUSING IN AREA SHOWN MEETS AFCI SPECIFICATION: GS-24-007.
6. MOUNTING HARDWARE: M2X0.8 SELF-THREADING SCREW
 MOUNTING SCREW LENGTH: 5.80±0.30mm.
7. PRODUCT PACKAGED IN TRAYS, REFER TO FCI SPECIFICATION GS-14-937.
8. HOUSING COMPONENT WILL WITHSTAND EXPOSURE TO 260°C PEAK TEMPERATURE FOR 60 SECONDS IN A CONVECTION, INFRA-RED, OR VAPOR PHASE REFLOW OVEN.
9. COPPER PLATING THICKNESS IN CENTER OF VIA-HOLE CAN BE NO MORE THAN 0.003 LESS THAN OTHER AREAS.
10. ALL HOLE SIZES ARE FINISHED HOLE SIZES.
11. A SYMBOL $\triangle C$ WILL BE NEXT TO ANY DIMENSION, VIEW, OR NOTE WHICH HAS BEEN MODIFIED WITH THE CURRENT DRAWING REVISION.

spec ref	-	dr	Zhao Peter	2013/12/23	projection	MM	size	A2	scale	2:1									
tolerance std	-	eng	Sunny2 Liu	2016/05/06			ecn no	ELX-DG-24036-1											
-	-	chr	Terris Liu	2016/05/20			rel level	Released											
-	-	appr	Pai-Ming Zheng	2016/05/24			product family												
surface	<table border="1"> <tr> <td>linear</td> <td>0.X</td> <td>±0.30</td> </tr> <tr> <td></td> <td>0.XX</td> <td>±0.25</td> </tr> <tr> <td></td> <td>0.XXX</td> <td>±0.15</td> </tr> <tr> <td>angular</td> <td>0°</td> <td>±2°</td> </tr> </table>	linear	0.X	±0.30		0.XX	±0.25		0.XXX	±0.15	angular	0°	±2°		title R/A OFFSET TYPE 16P16S HIGH POWER CARD EDGE			dwg no 10127949	rev C
linear	0.X	±0.30																	
	0.XX	±0.25																	
	0.XXX	±0.15																	
angular	0°	±2°																	
ASME Y14.5		cat. no.	-			Product - Customer Drw	sheet 4 of 4												