

NYLAKRIMP

MATERIAL: Copper
 PLATING: Electro-Tin (.0003 Min.)
 INSULATION: Nylon, Color Coded Blue
 STUD SIZES: "D" ±.005

*Optional Configuration

SD025

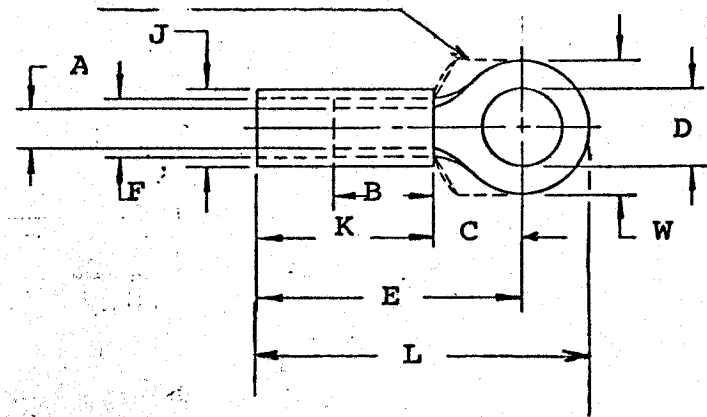

- 14 - .265"
- 56 - .390"
- 76 - .453"
- 12 - .515"
- 58 - .656"
- 34 - .781"
- 78 - .906"

Part Number	"W"	"C" Min.	"E" Max.	"K" Max.	"L" Max.	"A" Min.Avg.	"F" (MWID)	Stock Thickness	"J" MAX.AVG.	"B" Min.	Available Stud Size
L-795*	1.128 1.102	.822	2.382	1.590	3.001	.622	.836	.102	1.003	.725	38, 76, 12, 58, 14
L-798*	1.253 1.227	1.292	2.928	1.590	3.501	.622	.836	.102	1.003	.725	58, 34, 78

NOTE: (MWID) denotes maximum wire insulation diameter.



TITLE: CUSTOMER DRAWING
 4/0 WIRE RANGE (L)
 RING
 TONGUE TERMINAL

DIMENSIONAL TOLERANCE UNLESS OTHERWISE SPECIFIED		
FRAC.	DEC.	ANG.
±	±	±

REVISION	SCALE: ———	DATE
	DRWN. BY: JTK	1-21-70
	CHKD. BY:	
	APPRD. BY:	
A	ETC 50216 10/3 Rcm	DRAWING NO.: