

WE-SDT Rod Core Chokes THT



Design kit WE-SDT Rod Core Chokes THT



Characteristics

- High current capability
- Very reliable mechanical design
- Very high saturation performance

Design kit, free samples and customized designs available upon request



Order code 744 002, Version 3.0

Electrical properties

Order Code	L_{20} @ 20°C [μH]	R_{AC} @ 20°C [mΩ]	I_{max} [A]	$L_{50\%}$ [A]	Operating temperature range [°C]
Test condition	100 kHz/0.5V		40 K self heating	ΔL/L < 10%	including self heating
WE750	2.0 ^{+0%}	11.0 ^{+0%}	2.5	5.0	-40 to +170
WE753	2.0 ^{+0%}	6.5 ^{+0%}	5.0	18.0	
WE756	2.0 ^{+0%}	3.8 ^{+0%}	10.0	32.0	
WE759	2.0 ^{+0%}	1.7 ^{+0%}	15.0	34.0	
WE751	6.0 ^{+0%}	22.0 ^{+0%}	2.5	6.5	
WE754	6.0 ^{+0%}	11.7 ^{+0%}	5.0	15.0	
WE757	6.0 ^{+0%}	15.3 ^{+0%}	10.0	19.0	
WE760	6.0 ^{+0%}	3.5 ^{+0%}	15.0	45.0	
WE752	10.0 ^{+0%}	33.0 ^{+0%}	2.5	7.0	
WE755	10.0 ^{+0%}	15.1 ^{+0%}	5.0	11.5	
WE758	10.0 ^{+0%}	8.8 ^{+0%}	10.0	13.0	
WE761	10.0 ^{+0%}	5.7 ^{+0%}	15.0	56.0	

Dimensions

Order Code	Number of turns	Wire Ø [mm]	A [mm]	B [mm]	C [mm]	D [mm]	E [mm]
WE750	14.5 clockwise	Ø0.5	7.7 ^{+0%}	2.6 ^{+0%}	3 ^{+0%}	max. Ø3.2	12 ^{+0%}
WE751	21.5 clockwise	Ø0.5	11.5 ^{+0%}	3.6 ^{+0%}	3 ^{+0%}	max. Ø4.2	15 ^{+0%}
WE752	25.5 clockwise	Ø0.5	13.5 ^{+0%}	4.6 ^{+0%}	3 ^{+0%}	max. Ø5.2	18 ^{+0%}
WE753	11.5 clockwise	Ø0.8	9.7 ^{+0%}	4.9 ^{+0%}	3 ^{+0%}	max. Ø5.9	13.7 ^{+0%}
WE754	17.5 clockwise	Ø0.8	14.8 ^{+0%}	5.94 ^{+0%}	3 ^{+0%}	max. Ø6.9	20 ^{+0%}
WE755	22.5 clockwise	Ø0.8	19 ^{+0%}	5.9 ^{+0%}	3 ^{+0%}	max. Ø6.9	22 ^{+0%}
WE756	10.5 clockwise	Ø1.12	12.2 ^{+0%}	6.3 ^{+0%}	3 ^{+0%}	max. Ø7.6	15 ^{+0%}
WE757	15.5 clockwise	Ø1.12	18 ^{+0%}	7.3 ^{+0%}	3 ^{+0%}	max. Ø8.6	25 ^{+0%}
WE758	21.5 clockwise	Ø1.12	24.9 ^{+0%}	7.3 ^{+0%}	3 ^{+0%}	max. Ø8.6	30 ^{+0%}
WE759	9.5 clockwise	Ø1.8	17.5 ^{+0%}	8 ^{+0%}	3 ^{+0%}	max. Ø10	25 ^{+0%}
WE760	13.5 clockwise	Ø1.8	24.9 ^{+0%}	12 ^{+0%}	3 ^{+0%}	max. Ø14	30 ^{+0%}
WE761	16.5 clockwise	Ø1.7	29.2 ^{+0%}	14 ^{+0%}	3 ^{+0%}	max. Ø16	30 ^{+0%}

Dimensions

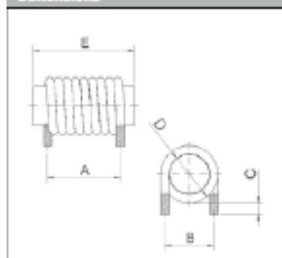

L vs. I WE750, WE753, WE756, WE759

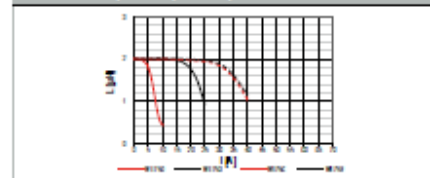

Insertion loss WE750, WE753, WE756, WE759

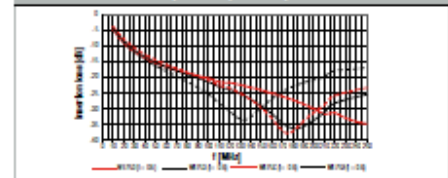

L vs. I WE751, WE754, WE757, WE760

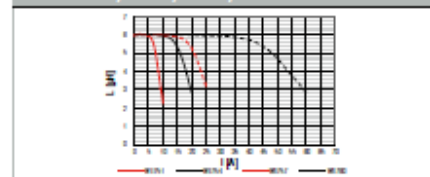

Insertion loss WE751, WE754, WE757, WE760

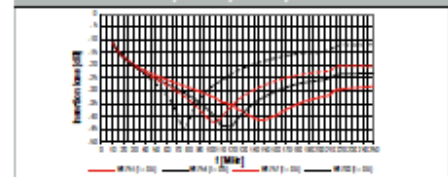

L vs. I WE752, WE755, WE758, WE761

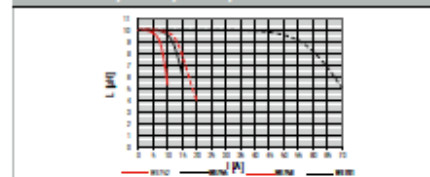

Insertion loss WE752, WE755, WE758, WE761

