

THIS DRAWING IS UNPUBLISHED. RELEASED FOR PUBLICATION
 © COPYRIGHT - By - TE CONNECTIVITY ALL RIGHTS RESERVED.

LOC	DIST	REVISIONS					
		P	LTR	DESCRIPTION	DATE	DWN	APVD
HB	-		C2	CHANGE LOGO&ADD LINE IDENTIFICATION ECO-12-001771	22Aug2012	YS.H	BH.Y

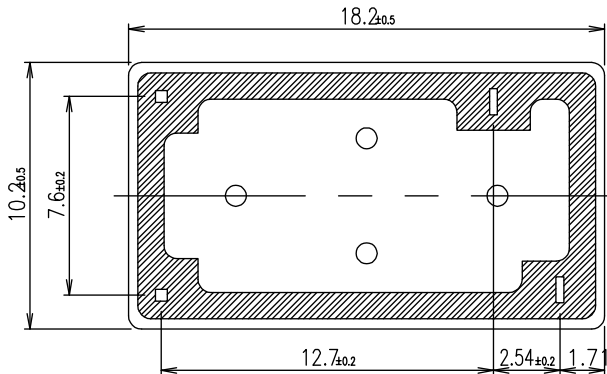
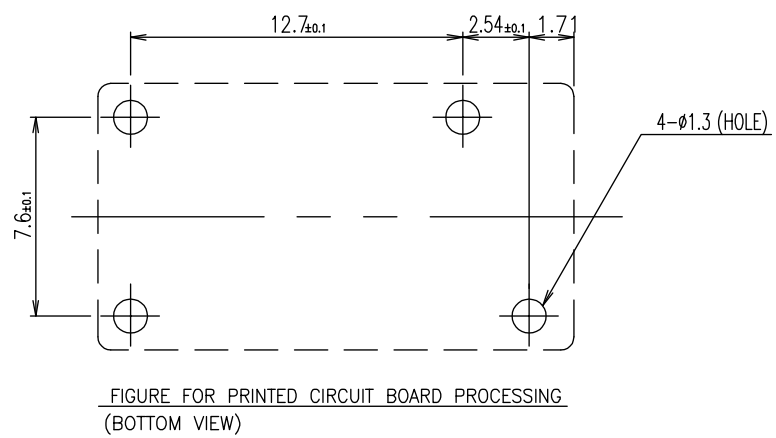
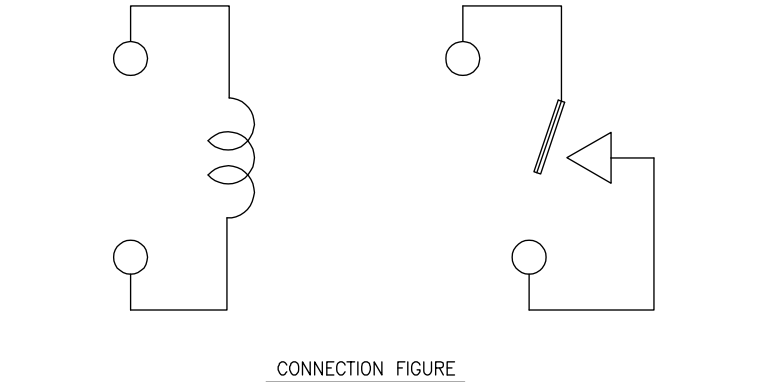
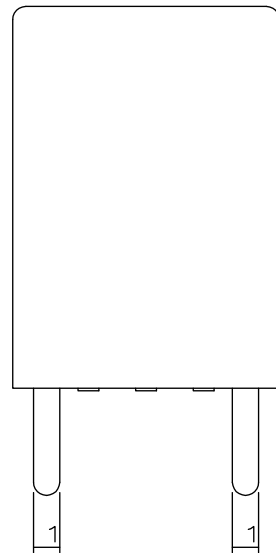
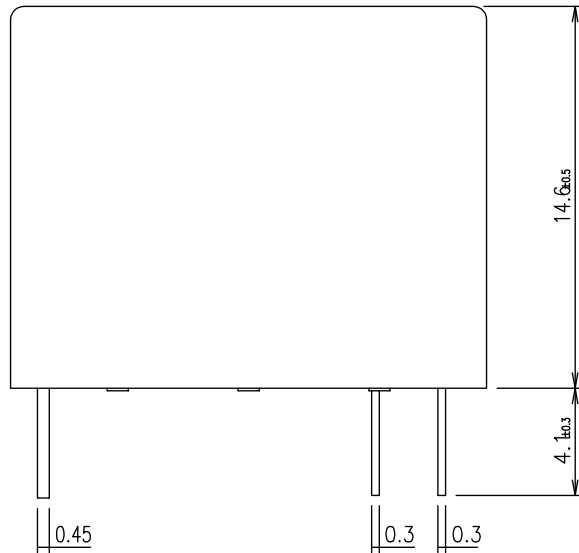
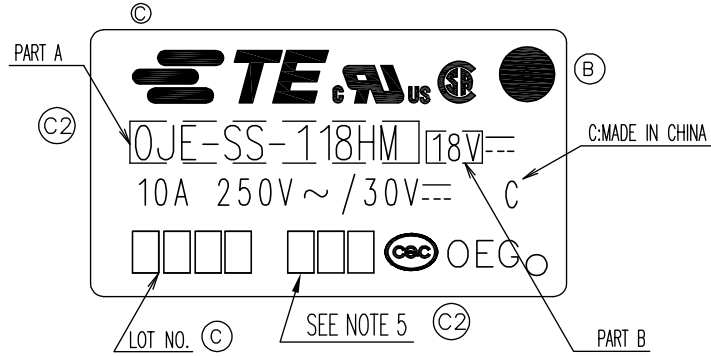

THIS DRAWING IS A CONTROLLED DOCUMENT.		DWN	H.Sasaki		TE Connectivity
DIMENSIONS: mm		CHK	Y.Oikawa		
TOLERANCES UNLESS OTHERWISE SPECIFIED:		APVD	A.Nagai		NAME
0 PLC ±-		PRODUCT SPEC	-		OJ-SH-HM SPEC,000 CUSTOMER DRAWING
1 PLC ±-		APPLICATION SPEC	-		RESTRICTED TO
2 PLC ±-		SIZE	A3	CAGE CODE	00779
3 PLC ±-		DRAWING NO	G= 1461405		
4 PLC ±-		WEIGHT	-		
ANGLES ±-		CUSTOMER DRAWING	SCALE	5:1	SHEET 1 of 2
MATERIAL	FINISH			REV	C2

THIS DRAWING IS UNPUBLISHED. RELEASED FOR PUBLICATION
 © COPYRIGHT - By - TE CONNECTIVITY ALL RIGHTS RESERVED.

LOC	DIST	REVISIONS			
P	LTR	DESCRIPTION	DATE	DWN	APVD
HB	-	SEE SHEET 1	-	-	-

PART STATUS	PART NO	DESCRIPTION	PACKAGE SPEC.	PART B	PART A	TYPE
ACTIVE	1461405-4	OJ-SH-148HM, 000	107-79010	48V	OJ-SH-148HM	g
ACTIVE	1461405-6	OJ-SH-124HM, 000	107-79010	24V	OJ-SH-124HM	f
ACTIVE	1461405-5	OJ-SH-112HM, 000	107-79010	12V	OJ-SH-112HM	e
ACTIVE	1461405-2	OJ-SH-109HM, 000	107-79010	9V	OJ-SH-109HM	d
Ⓒ2 OBSOLET	1461405-1	OJ-SH-106HM, 000	107-79010	6V	OJ-SH-106HM	c
ACTIVE	1461405-3	OJ-SH-105HM, 000	107-79010	5V	OJ-SH-105HM	b
Ⓒ2 OBSOLET	1461405-7	OJ-SH-103HM, 000	107-79010	3V	OJ-SH-103HM	a

ⒸⒷ NOTES:
 1. LOT NO. SYSTEM AS FOLLOWING: Ⓒ2 5. ADD LOT NO. SYSTEM AS FOLLOWING;

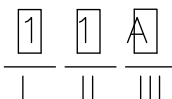
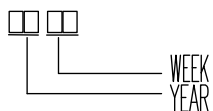

I, DIGITS FOR DAY OF THE WEEK
 1...MONDAY IN THIS WEEK;
 2...TUESDAY IN THIS WEEK;

 7...SUNDAY IN THIS WEEK
 II, DIGITS FOR SHIFT OF THE DAY
 1...DAY SHIFT IN THIS DAY;
 2...NIGHT SHIFT IN THIS DAY;
 III, ONE CHARACTER DISTINGUISH THE LINE
 IDENTITY,
 SUCH AS: A,B,....Z

- Ⓒ2 2. TERMINAL DIMENSION IS BEFORE SOLDER DIP;
- Ⓒ2 3. FOR THE TIN-PLATING OF THE PINS:
 +0.1mm FOR WIDTH, THICKNESS AND DIAMETER.
 +0.5mm FOR LENGTH.
- Ⓒ2 4. MARKING FROM INK TO LASER.

Diagram dimension	Tolerance
0.99mm max.	±0.1mm
1 - 2.99mm	±0.2mm
3mm min.	±0.3mm

RELAY TYPE

INCOMBUSTIBILITY	TREATMENT	MATERIAL	DESCRIPTION	ITEM
		UV RESIN	SEAL (VENT HOLE)	16
		EPOXY RESIN	SEAL (BASE & BOBBIN)	15
		3UEW	MAGNETIC WIRE	14
94V-0		P.B.T	CASE	13
94V-0		P.B.T	BASE	12
94V-0		P.B.T	BOBBIN	11
	SOLDER DIP	C.P WIRE	COIL TERMINAL	10
94V-0		P.P.S	CARD	9
		Ag ALLOY	MOVABLE CONTACT	8
		Ag	NO.CONTACT	7
		STEEL	HINGE SPRING	6
	SOLDER DIP	PBP	NO.TERMINAL	5
	SOLDER DIP	Cu ALLOY	MOVABLE SPRING	4
		NIP	CORE	3
		NIP	ARMATURE	2
		NIP	YOKE	1

THIS DRAWING IS A CONTROLLED DOCUMENT.		DWN	H.Sasaki	-
DIMENSIONS: mm		CHK	Y.Oikawa	-
TOLERANCES UNLESS OTHERWISE SPECIFIED:		APVD	A.Nagai	-
	0 PLC	± -		
	1 PLC	± -		
	2 PLC	± -		
	3 PLC	± -		
4 PLC	± -			
ANGLES	± -			
MATERIAL	FINISH	WEIGHT	-	
		NAME		
		OJ-SH-HM SPEC,000 CUSTOMER DRAWING		
SIZE	CAGE CODE	DRAWING NO	RESTRICTED TO	
A3	00779	C= 1461405		
CUSTOMER DRAWING		SCALE	SHEET	REV
		5:1	2 of 2	C2