

THIS DRAWING IS A CONTROLLED DOCUMENT.

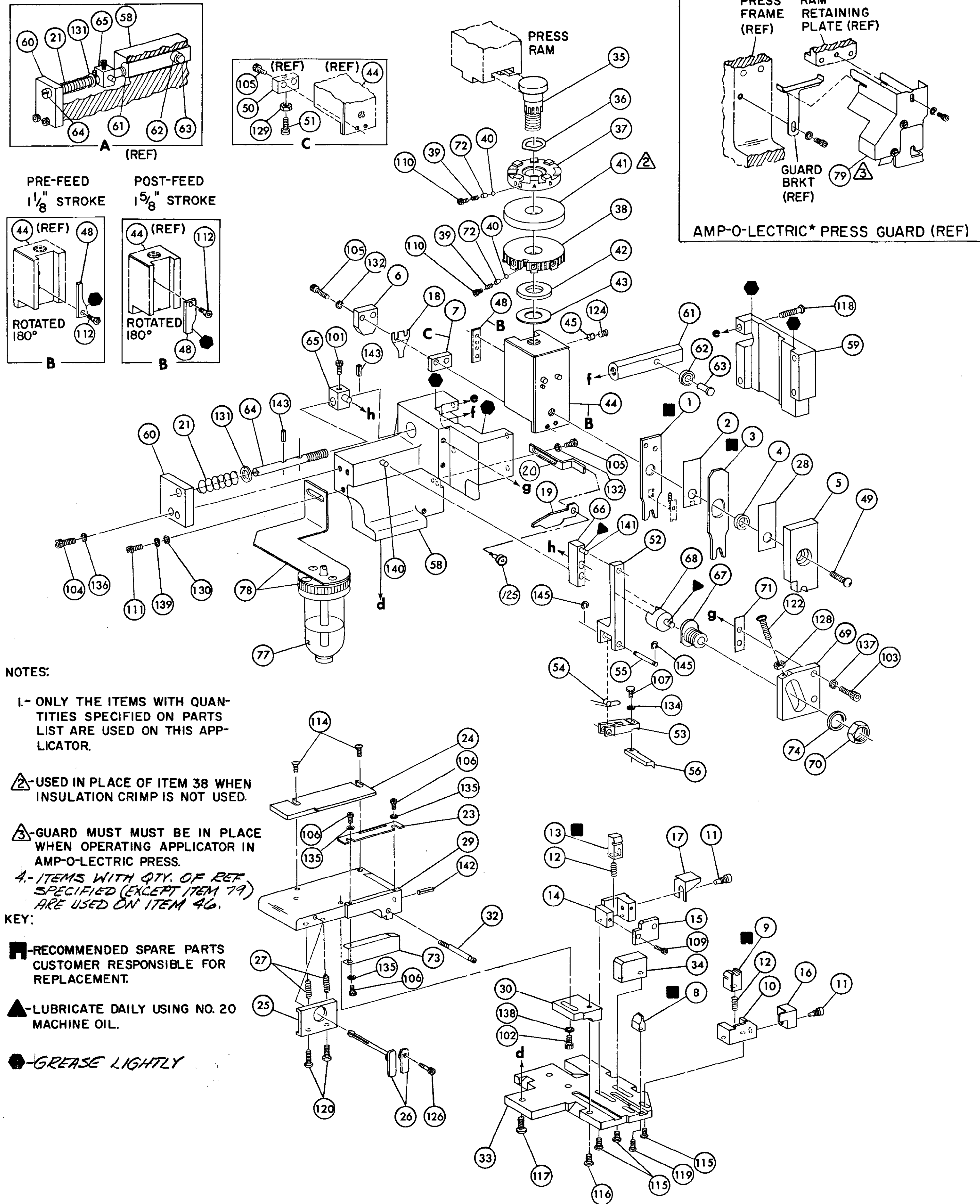

- NOTES:**
- 1- ONLY THE ITEMS WITH QUANTITIES SPECIFIED ON PARTS LIST ARE USED ON THIS APPLICATOR.
 - ▲ USED IN PLACE OF ITEM 38 WHEN INSULATION CRIMP IS NOT USED.
 - ▲ GUARD MUST BE IN PLACE WHEN OPERATING APPLICATOR IN AMP-O-LECTRIC PRESS.
 - 4- ITEMS WITH QTY. OF REF SPECIFIED (EXCEPT ITEM 79) ARE USED ON ITEM 46.
- KEY:**
- RECOMMENDED SPARE PARTS CUSTOMER RESPONSIBLE FOR REPLACEMENT.
 - ▲ LUBRICATE DAILY USING NO. 20 MACHINE OIL.
 - GREASE LIGHTLY

QTY	PART NO	DESCRIPTION	ITEM NO
REF.	21045-3	RING, RETAINING 'C' (.187 DIA) FEED FINGER PIN	145
REF.	5-21028-1	PIN, SLOT SPR (.125 DIA X .50) ADJ ROD	143
1	4-21028-0	PIN, SLOT SPR (.093 DIA X .75) STR G PLATE	142
REF.	1-21030-1	PIN, DOWEL (.187 DIA X .50) LEVER	141
REF.	1-21030-6	PIN, DOWEL (.187 DIA X 1.25) HOUSING	140
—	21024-5	WASHER, LOCK (NO 10) LUB ASSY	139
1	21024-5	WASHER, LOCK (NO 10) STRIP GUIDE ADJ BLOCK	138
REF.	21024-5	WASHER, LOCK (NO 10) ADJ PLATE	137
REF.	21024-5	WASHER, LOCK (NO 10) FEED GUIDE ROD	136
3	21057-2	WASHER, LOCK (NO 4) FRONT STRIP GUIDE	135
1	21024-4	WASHER, LOCK (NO 8) FEED FINGER	134
—	21024-4	WASHER, LOCK (NO 8) DEPRESSOR	133
3	21024-4	WASHER, LOCK (NO 8) STRIPPER	132
REF.	21899-4	WASHER, FLAT (5/16 DIA) SCREW ADJ	131
—	21899-2	WASHER, FLAT (NO 10) LUB ASSY	130
1	21018-5	NUT, HEX MACH (6-32) HOLDDOWN	129
REF.	21068-5	NUT, HEX MACH (6-32) FEED ADJ	128
—	22353-8	SCR, SHLD. (.187 DIA X .250 LG) DRAG LEVER	126
1	456567-1	SCR, SHLD. (.187 DIA X .125) STRIPPER	125
1	21009-2	SCR, SKT SET (1/4-20 X .25) (LOC-WEL) RAM	124
REF.	3-21064-2	SCR, RD HD MACH (6-32 X 1.50) FEED ADJ	123
2	2-21002-9	SCR, BUT HD SKT CAP (10-32 X .75) DRAG	122
1	22733-8	SCR, BUT HD SKT CAP (8-32 X .38) (LOC-WEL) ANVIL	121
REF.	2-21002-9	SCR, BUT HD SKT CAP (10-32 X .75) CAP	119
REF.	1-24073-9	SCR, BUT HD SKT CAP (1/4-20 X .75) HOUSING	118
REF.	2-21002-7	SCR, BUT HD SKT CAP (10-32 X .50) SG ADJ BLOCK	117
4	2-21002-2	SCR, BUT HD SKT CAP (8-32 X .50) SHEAR	116
2	2-21002-1	SCR, BUT HD SKT CAP (8-32 X .38) R STRIP GUIDE	115
1	2-21003-0	SCR, FLAT HD SKT CAP (6-32 X .50) CAM	114
—	3-21000-4	SCR, SKT HD CAP (10-32 X .38) LUBRICATOR ASSY	112
1	23030-1	SCR, SKT HD CAP (6-32 X .25) (LOC-WEL) CP DISC	111
—	—	SCR, SKT HD CAP (6-32 X .25) REAR SHEAR PLATE	109
—	—	SCR, SKT HD CAP (8-32 X .25) DEPRESSOR	108
1	2-22603-0	SCR, HEX HD MACH (8-32 X .31) FEED FINGER	107
3	1-21000-3	SCR, SKT HD CAP (4-40 X .25) F STRIP GUIDE	106
3	2-21000-7	SCR, SKT HD CAP (8-32 X .50) STRIPPER	105
REF.	3-21000-7	SCR, SKT HD CAP (10-32 X .75) FEED ROD GUIDE	104
REF.	3-21000-6	SCR, SKT HD CAP (10-32 X .62) FEED ADJ BLOCK	103
1	3-21000-4	SCR, SKT HD CAP (10-32 X .38) SG ADJ BLOCK	102
REF.	3-21000-4	SCR, SKT HD CAP (10-32 X .38) PIVOT BLOCK	101
REF.	455749-1	GUARD, WINDOW	79
—	1-465184-0	LUBRICATOR ASSY	78
—	—	OIL, LUBRICATING	77
1	21018-5	NUT, DEPRESSOR	76
REF.	458109-1	WASHER, SPECIAL	75
1	454877-3	PLATE, STRIP GUIDE COVER	74
1	690603-1	SPRING, ASSIST	73
REF.	690517-1	SPACER	72
—	22594-8	NUT, HEX	71
—	240628-1	PLATE, ADJUSTMENT	70
—	240626-1	SHAFT, PIVOT	69
—	240633-1	BUSHING	68
—	455680-1	LEVER, INTERMEDIATE	67
—	240629-1	BLOCK, PIVOT	66
—	240632-2	SCREW, ADJUSTMENT FEED ROD	65
—	240659-3	PIN, CAM ROLLER	64
—	240658-1	ROLLER, CAM	63
—	454398-2	ROD, FEED	62
REF.	454178-1	GUIDE, FEED ROD	61
REF.	454220-1	CAP, HOUSING	59
REF.	454485-1	HOUSING	58
—	690542-2	PAWL, FEED	57
REF.	240624-1	PIN, FEED FINGER	56
REF.	691499-1	SPRING, FEED FINGER	55
REF.	690541-1	FINGER, FEED	54
REF.	455679-1	LEVER, TERMINAL FEED ARM	53
—	611242-2	BUMPER, HOLDDOWN	52
—	690753-1	SPACER, TONKER	51
—	7-21002-9	BOLT, CRIMPER	50
—	690602-5	CAM PRE-FEED 1/8 STROKE	49
—	459456-1	APPLICATOR, BASIC (SUB ASSY)	48
—	690191-1	PLUG, NYLON	47
—	455673-1	RAM	46
—	690125-1	WASHER, LAMINATED	45
—	690124-1	WASHER, RAM	44
—	690223-1	DISC, SPACER	43
—	23241-6	BALL, STEEL	42
—	690170-1	SPRING, COMPRESSION	41
—	—	DISC, INSULATION	40
—	3-690141-4	DISC, WIRE	39
—	22480-5	WASHER, SPRING	38
—	690212-1	POST, RAM	37
—	690786-3	SUPPORT, TERMINAL	36
REF.	455675-1	PLATE, BASE	35
—	690432-3	SCREW, ADJUSTMENT	34
REF.	455689-1	BLOCK, STRIP GUIDE ADJ	33
—	1-455671-6	PLATE, STRIP GUIDE	32
—	2-455888-2	SPACER, FRONT SHEAR DEPRESSOR	31
—	1-22284-0	SPRING, DRAG	30
—	690546-1	LEVER, DRAG RELEASE	29
—	240792-1	DRAG, STOCK	28
—	2-690440-6	GUIDE STRIP (REAR)	27
—	690438-1	GUIDE, STRIP (FRONT)	26
—	—	SPRING, FEED RETURN	25
REF.	4-22284-9	ARM, STRIPPER	24
—	458950-1	STRIPPER	23
—	458949-1	HOLDER, TERMINAL	22
—	—	GUARD, CHIP (REAR)	21
—	691667-1	GUARD, CHIP (FRONT)	20
—	—	PLATE, SHEAR (REAR)	19
—	—	HOLDER, SHEAR (REAR)	18
—	—	SHEAR, FLOAT (REAR)	17
—	5-22280-0	SPRING, SHEAR	16
—	690461-1	STOP, SHEAR	15
—	690459-1	HOLDER, SHEAR (FRONT)	14
—	454276-1	SHEAR, FLOAT (FRONT)	13
—	1-683403-5	ANVIL	12
—	—	SPACER, DEPRESSOR (REAR)	11
—	—	DEPRESSOR, SHEAR (REAR)	10
—	455889-9	DEPRESSOR, SHEAR (FRONT)	9
—	—	SPACER, TUBULAR, INS CRIMPER	8
—	—	CRIMPER, INSULATION	7
—	—	SPACER, CRIMPER	6
—	—	CRIMPER, WIRE	5
—	—	CRIMPER, WIRE	4
—	—	CRIMPER, WIRE	3
—	—	CRIMPER, WIRE	2
—	—	CRIMPER, WIRE	1

REMARKS		NO	REV
—INACTIVE—			
APPL USED ON MACHINE PART NO		MACH SERIAL NO	DISTRIBUTION
CUSTOMER NAME		APPL SERIAL NO	ORIGINAL
ADDRESS		PURCHASE ORDER	CUSTOMER COPY
CITY		ENG APP	FIELD ENG COPY

CRIMPING DATA				APPLICATOR WILL APPLY	
PAD LTR	CRIMP HEIGHT	WIRE SIZE	WIRE STRIP LENGTH	61463	
A	.040	20			
B	.037	22			
C	.034	24			
D	NOT USED				

CRIMP	SIZE	TYPE	FEED	APPL INST
WIRE	070	F		A1 8040
INSUL			.300	

WIRE RANGE 24-20 INSULATION RANGE PRESS NO 565435-5

REMARKS PRE-FEED AMP-O-LECTRIC

DIST 66

AMP 2983-3 (8-73)



AMP INCORPORATED Harrisburg, Pa.

NO 466474-4

MINIATURE QUICK CHANGE APPLICATOR SIDE FEED (EXTRUDED RING)

CUSTOMER AND ASSEMBLY DRAWING